

Designs only on this number, without letters

N^o 5012

Place Wellesley, Massachusetts
Building First Congregational Church, Chapel
Persons Interested The Rev. John E. Wallace

Date of Completion.....

Minister see above Denomination.....

Architect.....

Vents.....

Position in Church 5 Aisle windows, 3 east, 2 west

Height from floor..... Protection Glass..... Groove Rabbet..... Metal Stone Wood.....

Exposure east - west Footage 29 feet each

Inscription For the Jonathan Edwards Window,-
Mary - Florence - Barbara
Bolles (slightly larger)
Orange, or yellow day lily and fern, in place of Trinity.
Also narcissus, on the other side.

Design wanted..... Staging.....

Templates..... Blueprints.....

Passels

GRAVES WINDOW

General Information.....
William Bradford (A) ✓ East ✓ completed
John Winthrop (B) East
Thomas Hooker (C) ✓ East - Delia Newton Graves
* Jonathan Edwards (D) ✓ West Bolles (GREEN)
Roger Williams (E) ✓ West ✓ completed

*Dr. Wallace wants to see the cartoons of the Edwards window with the donor.

(over)

Edwards window will go in the first position from the door on the street side.

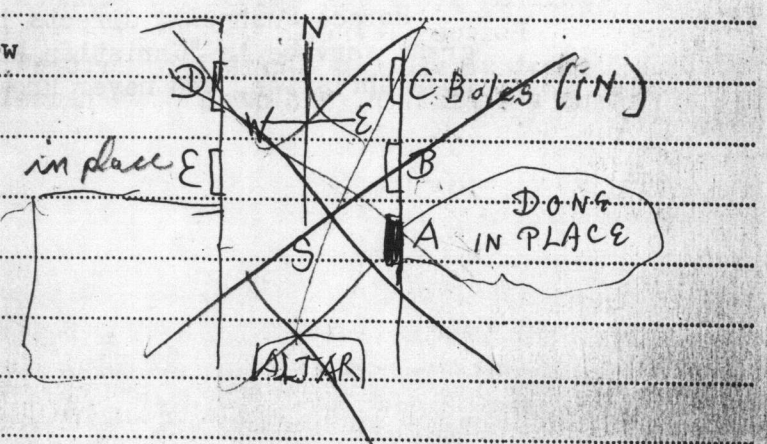

Thomas Hooker Window.

This window sets forth champions of the New England Way. Thomas Hooker, founder of American constitutional government holds the dominant position.

Above is a suggestion of the migration of his congregation to Hartford (including the cattle); and at the top, the text of his sermon before the General Court of Connecticut,- "The foundation of authority is laid in the free consent of the people".

John Cotton, "Patriarch of New England", preaches from t of the First Church of Boston. The symbol recalls his writings "Keys to the Kingdom of Heaven".

John Wise, pastor of Ipswich, develops their thesis supporting the government of the New England Churches in personal liberty and equality, later affirmed in the Declaration of Independence.

Edwards window.

This window celebrates the tremendous contributions of Jonathan Edwards and Horace Bushnell to the advancement of Congregationalism.

Jonathan Edwards, of Northampton, theologian and "Preacher of the Great Awakening", holds the dominant position.

The symbols above him suggest his defense of the sovereignty and grace of God and the validity of His moral order. The open book represents his philosophical thesis on the "Freedom of the Will". The chalice symbolizes his refusal to recognize the Half Way Covenant; and the spider,- his essay calling it "a fit symbol for sinners".

Horace Bushnell, directs his attention to the child, his great service in "Christian Nurture", - "the child is to grow up a Christian, and never know himself as being otherwise".

#5012 A - (B) - C - D - E

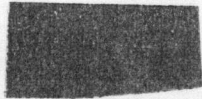

Wellesley Hills, Massachusetts
First Congregational Church.



#5012B

The John Winthrop Window

Mr. Wires wants Winthrop in position
like the post card, with ropes and
rigging.

Lettering "Arbella. 1630."
Indian out.

Small figure of Endicott below.

Inscription:

Helen Mead Wires
(with a space for)
E. Stanley Wires
(to be added later)

R E D

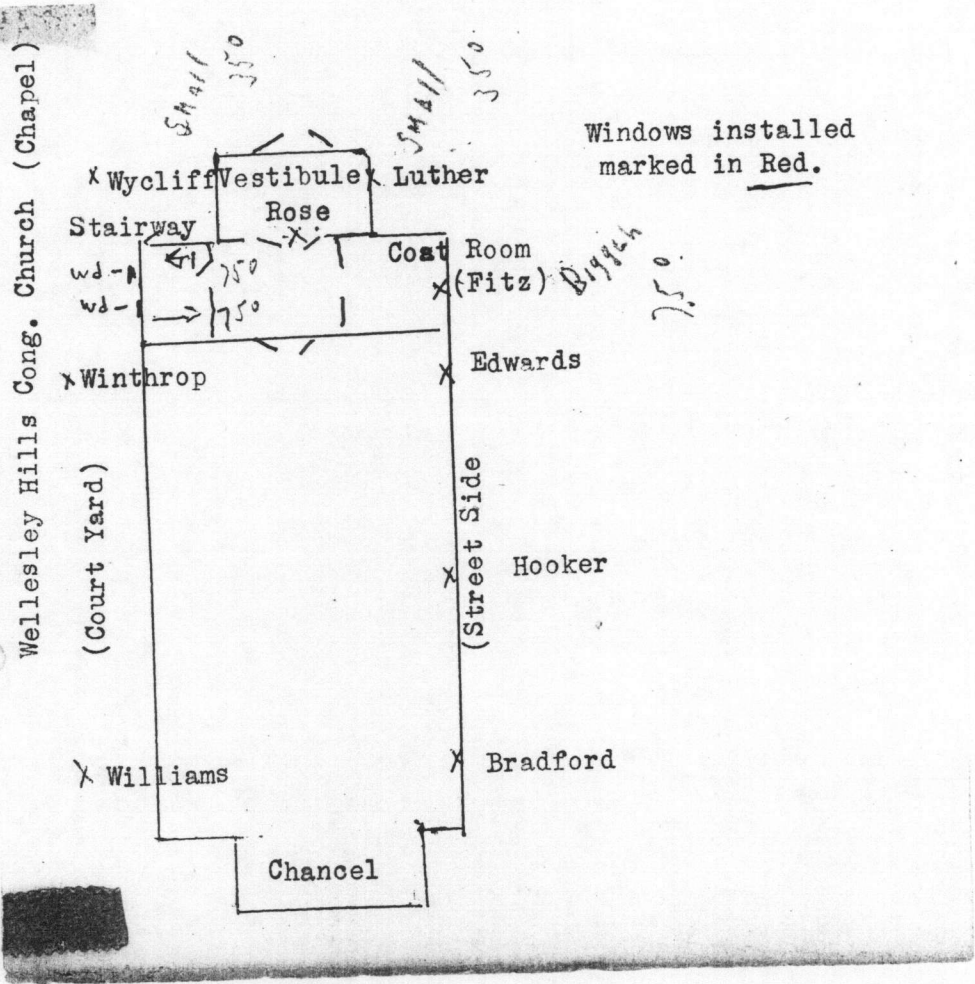

5012A
Nº [redacted]

Place Wellesley Hills, Mass.

Building First Congregational Church, Chapel Date of Completion May 1968

Price: \$2,200.00

Persons Interested

Profit \$595.68 - .271%

Minister The Rev. John E. Wallace Denomination

Architect

Vents Yes in place

Position in Church East Aisle (or nave)

Height from floor	Protection Glass	Groove Rabbet	Metal Stone Wood
-------------------	------------------	---------------	------------------

Exposure East Footage 29 feet (@ ^{75.86} \$56.41)

Inscription

1921-Elizabeth Benedict Johnson-1965

Design wanted Staging

Templates Blueprints

General Information ~~Governor-Bradford~~
William Bradford

5012B

Nº [redacted] J

Place Wellesley Hills, Massachusetts

Building First Congregational Church

Date of Completion May 13, 1969

Persons Interested The Reverend John E. Wallace

Minister Denomination

Architect

Vents

Position in Church

Height from floor.....	Protection Glass.....	Groove Rabbet.....	Metal Stone Wood.....
------------------------	-----------------------	--------------------	-----------------------

Exposure..... Footage.....

Inscription Helen Mead Wires
 (with a space for)
 E. Stanley Wires
 (to be added later)

Design wanted..... Staging.....

Templates..... Blueprints.....

General Information The Winthrop Window

Mr. Wires wants Winthrop in position like the post card, with ropes and rigging.

Lettering "Arbella. 1630."

Indian out.

Small figure of Endicott below.

5012E

Place Hills,
Wellesley, Massachusetts

No. [REDACTED]

Building First Congregational Church Chapel Date of Completion.....

Persons Interested The Rev John E. Wallace Price: \$2,200.00

Profit: \$171.48 - .078%

Minister..... Denomination.....

Architect.....

Vents.....

Position in Church Aisle window Epistle side West

Height from floor..... Protection Glass..... Groove Rabbet..... Metal Stone Wood.....

Exposure West Footage 29 feet @ \$75.86

Inscription "Maude Elizabeth Taylor"

Design wanted..... Staging.....

Templates..... Blueprints.....

General Information { "Roger Williams" (aisle, recent channel on Epistle side)
"John Eliot" }

