

Nº 5033

Place Nampa, Idaho

Building Grace Episcopal Church
P.O. Box 937, Nampa

Date of Completion August 1, 1967

Persons Interested Parish Sec.: Mrs. Verda Tyler, (Price: \$1,500.00 F.O.B. Nampa)

Profit \$54.55 - .037%

Minister ^{MYERS} The Rev. Harold V. Meyers, Rector
915 4th Street So. Nampa, Idaho

Denomination

Architect

Vents *written about*

Position in Church

Height from floor

Protection Glass

Groove Rabbet

Metal Stone Wood

Exposure Northwest (& Southeast (Bright Light)) Footage 20 feet each
(St. Luke) (Abraham) (Clear Air) (@ \$75.00 per)

Inscription

To the Glory of God and in loving memory of James Carlton Rawlings

See Below

Glass used: 20 Feet @ \$1.50

\$30.00

Scrap \$ 2.00

Total \$32.00

Design wanted

Staging

Templates

Blueprints

General Information

("Abraham") "St. Luke" (In Luke's window, put a "Caduceus"
this to go on #5118 (in some "inconspicuous spot")

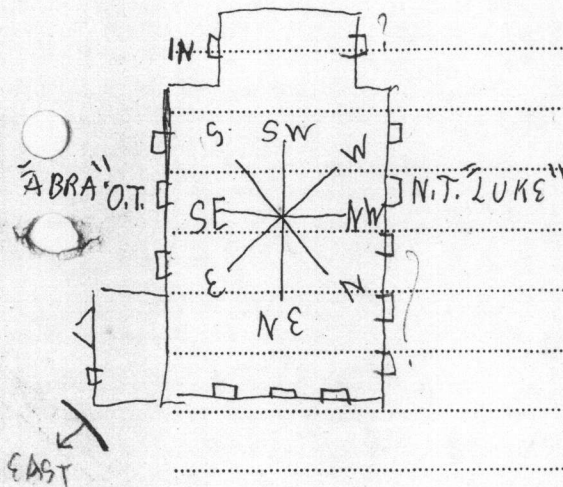

The Rev. H. V. Myers went to Boston University School of Theology in the 1930's and was much impressed with the Connick Windows in the Robinson Chapel and hopes he can have something similar

As planned, they are devoted to Abraham and Saint Luke, designed in the character of our windows in Boston University Chapel.

The patriarch, Abraham, carries the brazier of fire, while the sacrificial altar is represented below. Above is the text, "By Faith...when he was called, obeyed". The foliated grisaille field is similar to the Boston University windows, as is the border of grapevine.

Saint Luke holds the Evangelistic pen and book with his traditional symbol, the winged Ox below. Here the border is of the rose pattern.

These windows will be in rich, deep color, very well textured for your light. We may consider these designs as suggesting brilliant illumination.