

No 4085

Place Billings, Montana.  
Building Saint Luke's Episcopal Church.  
Persons Interested  
Date of Completion  
Price: \$1400 ea pair.  
(\$87.500)

Minister Denomination Episcopal.

Architect Whitehouse, Price, DeNeff and Deeble, Architects, Hutton Building, Spokane, Washington.

Vents

Position in Church Aisle Windows: 5 double windows on S.E. side (Epistle); and 2 double windows on N.W. side (Gospel). Altar is N.E.

Height from floor about 4' Protection Glass Groove Rabbet Metal Stone Wood

Exposure 5 S.E.; 2 N.W. Footage 16' in pair.

Inscription

Design wanted soon. Staging

Templates Blueprints

General Information Make typical sketch: Annunciation and Nativity.

Something like the windows in St. Michael and All Angels, Portland, Ore, and St. Luke's Church, Denver.

(The window over the altar represents the Angel at the Tomb Announcing the Resurrection to the Three Marys. )

Perhaps devote the aisle windows to significant incidents from the Life of Christ, from the Annunciation and Nativity to the Passion and Crucifixion, with the altar window symbolizing the culmination in His final Triumph over Death. - Colorful medallions, borders and symbols, and simple fields.

The subjects might include such themes as The Annunciation and Nativity; the Boy Christ in the Temple with the Doctors, and the Baptism by St. John the Baptist; the Calling of the Disciples to be Fishers of Men, and the Sermon on the Mount; a Miracles window, with such themes as the Healing at the Pool of Bethesda and the Raising of Jairus' daughter; a Parables window, perhaps devoted to the Good Samaritan and the Prodigal Son; a window suggesting Our Lord's friendship and compassion for His friends representing Him in the Bethany home of Mary and Martha, and Blessing Little Children; and finally, His Passion with the Last Supper and the Crucifixion. (See photographs of interior and exterior of church in folder.)

Whitehouse says this is not a rich church - keep cost down.

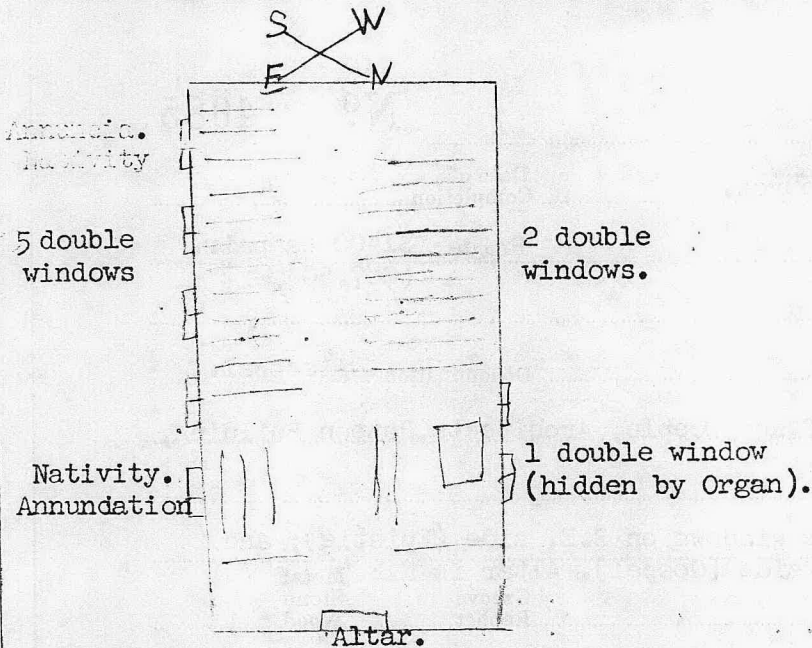

Completed our study of the side windows for Saint Luke's Church in Billings, and are sending you the typical sketch, herewith.

Keeping in mind the plan to devote these windows to significant incidents from the life of Christ, this typical design is devoted to the first two, - the Annunciation and the Nativity.

In the first panel the Blessed Virgin kneels in prayer while the Angel of the Annunciation appears to her. Above is the Descending Dove of the Holy Spirit.

In the balancing panel the Holy Child is shown in the manger between the Blessed Virgin and Saint Joseph who bears his traditional flowering staff. Above is the Star of the Nativity.

In the smaller medallions below are the traditional symbols of the Blessed Virgin, - the vase of red roses for Divine Love and the vase of white fleur-de-lys for Purity.

The Cherubim enriches the treasury; and a space is provided at the base for a memorial inscription if one is required. Otherwise a significant text could well be placed here.