

Nº 4503

Place Chattanooga, Tennessee,.....

Building Grace Episcopal Church, 4010 Brainerd Road. Tel. MA 2-7616.

Date of Completion \$1100 ea panel, (\$78.61) Price or perhaps \$2000 for pair set at one time. (\$71.43). 10/2/61.

Persons Interested Committee member, Mr. Moulton.

The Rev. Leon C. Balch.

Minister Rector's office phone: MA. 4-5651.

Denomination Episcopal.

Architect Barber and McMurry, Knoxville.

Vents Casements in cusped headed windows.

Position in Church Aisle Window.

Height from floor 4 feet.

Protection Glass.

Groove Rabbet.

Metal Stone * Wood

Exposure All windows get good light. N.E. & S.W.

Footage 28 feet. 24?

Inscription

Design wanted

Staging

Foster Art Glass Co., 2365 Roosevelt Boulevard, Chattanooga are only good people there. Templates Tel. AN 6-2081. Mr. W. A. Elrod. Blueprints

General Information Theme: Annunciation and Epiphany, for the first window.

They would like to represent the major Feast Days of the Calendar, fixed and movable, and the one fast. This will include the Annunciation, Purification, Circumcision, Epiphany, Good Friday (Crucifixion), Saint Stephen, Holy Innocents, Saint John the Evangelist, All Saints; and certain saints can be combined, such as Luke and Andrew, and those who went on Missionary Journeys together. Dr. Balch will study this plan and send us his scheme.

* There are casements occupying nearly half of all the cusped-headed aisle windows - 9 in all. (O.E.S. notes 4/11/61 says "There are 11 aisle windows in all, including the two rectangular pairs, all double, making 22 panels, ~~MA~~

28
80
2240

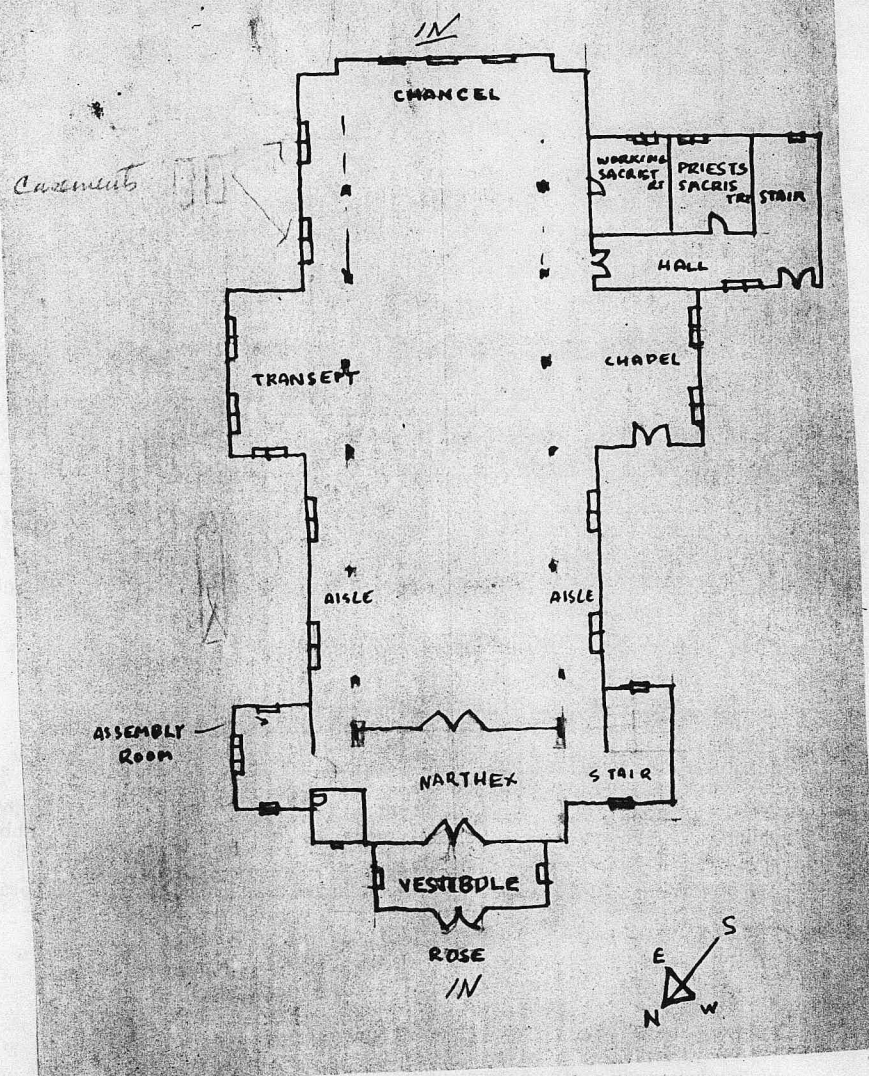

rough color sketch, herewith. It is planned to harmonize beautifully with your chancel window and also the rose.

We have suggested the Annunciation and the Epiphany themes in the principal medallions.

Below are Angels of praise and prayer bearing trumpets and censers.

Significant symbols are introduced between these and at the base, - the Heavenly Crown and the traditional monogram of the Blessed Virgin; the Star of Bethlehem and the Chi Rho.

The growing vine forms enriching the fields and outlining the medallions flower in fleur-de-lis of Purity.

It is our thought to alternate the arrangement of the dominant colors, - ruby and blue through the series. Blue would take the position of red and vice versa in the neighboring windows. This alternation throughout would add interesting variety without disturbing the over-all color balance.