

$$\begin{array}{r} 73 \\ 234 \\ 78 \\ \hline 104 \end{array}$$

$$\begin{array}{r} 2 \\ 350 \\ 4 \\ \hline 1400 \end{array}$$

No 3839

Place Rochester, New York,
 Building St. Paul's Church. (Episcopal. 13 Wick Park B.) Date of Completion April, 1957.
 Persons Interested Mr. Charles K. Hallebush. Price: \$1400 for the 4 panels.
\$78.00 per foot.

120 36 1/3 - 7/0 # 576.35

Minister..... Denomination Episcopal.

Architect.....

Vents Yes. Eliminate. 1/24/57.
 (3-panel group, nearest entrance.)

Position in Church Chapel. (Single panel aisle window, nearest chancel)

Height from floor.....	Protection Glass.....	Groove Rabbet.....	Metal Stone Wood.....
------------------------	-----------------------	--------------------	-----------------------

Exposure N.E. Footage 4 1/3' in single panel
13' in 3-panel group.

Inscription For the 3-panel group "To the Glory of God and in Memory of
Ruth Wilson Farrow 1898-1947".
 No inscription in the single panel.

Design wanted Before August 20th. Staging.....

To be installed by Mr. Frank Paul, 92 Front St. Rochester 4, N.Y. (The Melen
 Templates Glass Works Blueprints.....

General Information (There is also a 3-panel group on the same side, nearer
the door. (See floor plan in black book. 4 1/3' in each
panel.)

To be colorful figures or medallions in light fields, something like our windows in St. Stephen's Church, Pittsfield, N.H. and Springboro; or backgrounds could be of the rich foliated type as in the photographs of Gloucester, Sunday Sch. Chapel, Fourth Pres. Chicago, and Holderness School, Plymouth - quite light with lacy patterning. Light tinted diamonds, with a colored border and central medallions with figures.

Make design with ~~figure in center~~ and medallions in side panels - on light background; perhaps similar to the Pittsfield window, with insets; and color line border.

Eucharistic Christ (Christ holding Chalice) in single panel. Simple
representations of Miracle at Cana, Blessing Children, Raising Lazarus in
group of three.

For the 3-panel group: Subjects related to the more intimate aspects of Our Lord's life: colorful medallions representing the First Miracle at the Marriage at Cana, Blessing little Children, and the Raising of Lazarus.

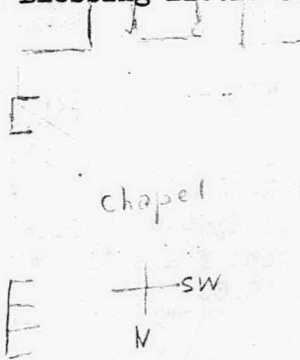

Designs for Chapel windows. They are in light fields accented by colorful medallions, borders and other accents, in a freely composed leaded diamond pattern.

The single one nearest the altar is devoted to the Eucharistic Christ in the attitude of blessing, holding the chalice.

The group of three lancets is devoted to the Miracle at the Wedding Feast at Cana (right). Christ Blessing Little Children, and the Raising of Lazarus.

The light silvery fields are designed to admit an abundance of illumination to the Chapel, and are enriched with foliated pattern and occasional symbolism.