

General contractor is Theodors Loranger and Sons, New Bedford.

2200  
660  
200  
3060

No 3677

Place Fairhaven, Massachusetts.

Building Chapel of Our Lady's Haven.

Date of Completion *not dated*  
*put in summer 1955*

Carmelite Sisters for the Aged and Infirm.

Persons Interested Reverend Mother M. Alodia, O.Carm., Mother Superior, 71 Center Street, Fairhaven, Massachusetts.

Price: \$2200 (\$30.).

*Profit .292 #64251*

Minister Reverend Raymond T. Considine, S. Williams Church, 42 Chicago St. Wall River. Denomination Roman Catholic.

Architect Wendell T. Phillips, Milford, Massachusetts.

Vents

Position in Church 5-panel group, with transoms, at rear of Chapel, opposite Chancel.

Height from floor about 3 feet. Protection Glass. Groove Rabbet. Metal Wood, double Stone Wood hung.

This bay gets pretty good light.

Exposure North. Footage 73' total in group.

Inscription

Design wanted SOON.

Staging

Templates

Blueprints

General Information Father Considine suggested symbols instead of figures of the Blessed Mother, and maybe the Sacraments.

Keep light and airy and delicate - devote group to the Seven Sacraments and the Virtues - left to right in transoms - Prudence, the Lamp; Faith, the Cross; Charity, the Flaming Rose; Hope, the Anchor; and Justice, the Scales. (The other two Virtues to go in the side windows).

Upper portion of the panels - left to right, Holy Orders, the Mitre; Baptism, the Shell; The Eucharist, Chalice and Host; Confirmation, the Dove; and Matrimony, Entwined Rings.

Seen close -

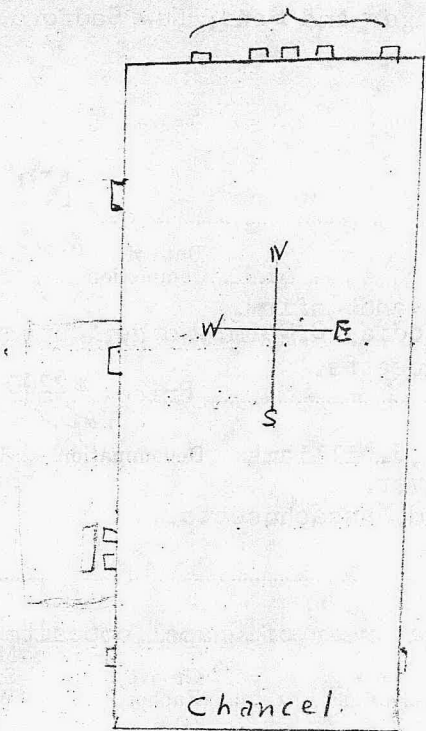

Note: We are to eliminate the symbols of the Virtues, and instead use the Monogram symbol of the Blessed Virgin, that was designed for the transom over the door, in the center panel of the group ~~over~~ <sup>transom of the</sup> opposite the chancel. In the other transoms of this group, use symbols related to the queenship of Our Blessed Mother, from the Litany - each to have a crown over the symbol, as follows.  
 Queen of the Holy Rosary - the Rosary  
 Queen of Martyrs - The Palm and martyr's sword.  
 Queen of Angels - Small Angel  
 Queen of Virgins - Fleur-de-lys.

IMPORTANT: Center group - Holy Eucharist and Monogram of Mary to remain as in the design; But, place the remaining in the following order:

- Queen of Rosary over Matrimony
  - Queen of Martyrs over Penance (Side window).
  - Queen of Angels over Baptism
  - Queen of Virgins over Confirmation
  - Queen of Peace over Extreme Unct.
  - Queen of Prophets over Holy Order
- (Side Window)

It is our thought to devote the group of five windows, opposite the chancel and the two at the side, to the Seven Sacraments.

In the color sketch, the symbol of the Holy Eucharist, - the Chalice and Host, occupy the central position, with the Shell of Baptism at the left and the Dove of Confirmation at the right.

In the outer panels, the Miter symbolizes Holy Orders, and Entwined Rings with Our Lord's monogram, for Matrimony.

In the two side windows, Penance would be symbolized by the Scourge; and Extreme Unction, by the Altar bearing the Candle and Cross.

~~In the transom above, we have introduced the virtues. The theological virtues in the central group are symbolized by the Cross of Faith, the Anchor of Hope, and the Flaming Heart of Divine Love. The Cardinal virtues begin in the outer panels with the Lion of Fortitude and the Scales of Justice. They would be continued in the two side windows with the Lion of Fortitude; and the Pitcher of water for Temperance.~~

~~We have kept the palette light and brilliant, as easily in the transom over the door in recognition of the sacred mystery. However, we have introduced an abundance of pure, rich color through the symbols and hardware.~~

we have introduced the sacred monogram of Our Lady. The other transoms have symbols relating to the Queenship of our Blessed Mother. The first at the left symbolizes the Queen of the Holy Rosary. The cross and palm symbolizes the Queen of Martyrs, the Kneeling Angel, - Queen of Angels; and the fleur-de-lys, - Queen of Virgins. Each symbol is crowned.