

CHARLES J. CONNICK : DESIGNER AND WORKER IN STAINED AND
LEADED GLASS : NINE HARCOURT STREET, BOSTON, MASSACHUSETTS

City or Town Brookline, State Mass. No. 2565
Church First Parish Church. Date of Completion May 13, 1945.
Donor and Address Mrs. Albert F. Bigelow, 246 Dudley Street, Brookline, Mass.
Donor: Mr. Fletcher, Frederick C.,
101 Newbury St. Boston. Quality of Glass ~~\$1100.00~~ \$2000 for 2
~~\$45.05 per foot.~~
(1000 if 2 or more are made
at same time. \$42.)
Architect Rev. Carl Bihldorff, The Parsonage,
Denomination and Minister 353 Walnut Street, Brookline.
Footage 24 feet each sight Sizes, full
Ventilators Remove vents. Set by
Position in Church 2 Clerestory windows nearest altar.
Height from floor 20 feet Protection Glass No. Groove Rabbet Stone Wood
Points of compass
Quality of light 1 north; 1 south.
Inscription In Memory of Selina Huntington Jarvie Fletcher
(in each window).

Design wanted _____ Staging _____
Shipping address _____ Blue-prints _____
Received _____

Bill to _____ Templets _____
Photos of Cartoons Mailed _____

General Information (These are two of four clerestory windows, 2 north, 2 south.)

The central theme is St. John's evangelical symbol, the eagle - with kneeling Angels of Praise and Prayer, with trumpet and censer, at either side. The blue border of decorative cloud forms is accented with stars of divine faith and steadfastness. The whole composition is kept very light, with a silvery field accented and given warmth in passages of gold and notes of ruby. At the same time there are included enough fine pure blue to relate these windows to those in the lower range. While the entire composition is kept light, the illumination is well controlled by foliated grisaille pattern which will diffuse the light and relieve its intensity.

Description of designs: for the two windows nearest the altar. We have devoted one window to Our Lord, symbolized by the Agnus Dei, - the Lamb with the cruciform halo and banner inscribed with the cross. The other is devoted to the Blessed

For addresses of those to be notified as window progresses, see other side.

Virgin Mary, symbolized by the traditional symbol of the Enclosed Garden of roses and lillies.

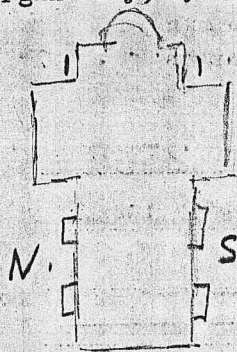

(Note: C.J.C. thought the window at the left could be a symbol of Christ, the Lamb of God; the one at the right (south) symbol of the Blessed Virgin. He suggested the "Enclosed Garden" might be largely lilies. ~~He thought both symbols could be crowned with a starry crown, just above the ventilator bar.~~)