

Mrs. Harry E. Barton, 3 Fletcher Street, Roslindale, Mass.  
(Another sister of Mr. HORMEL. Par. 5830-W)  
CHARLES J. CONNICK : DESIGNER AND WORKER IN STAINED AND  
LEADED GLASS : NINE HARCOURT STREET, BOSTON, MASSACHUSETTS

City or Town West Roxbury State Mass. No. 2091  
(leave Center St. on Park St.). Date of April 9.  
Church Emmanuel Church, Stratford St. & Clement Av. Completion Easter 1939.  
Donor and Mr. Hormel and his sister.  
Address Herman Hormel, Jr. c/o Carter Ledyard & Milburn, 2 Wall St. N.Y.C.  
Mrs. Malcolm Norling, 103 Selwyn St. Roslindale, Sister  
Architect \_\_\_\_\_ Quality of \$600  
Glass (\$66.66 per foot).  
Denomination Episcopal.  
and Minister Rev. P.T. Schultz, Jr.  
Footage 8½ feet in 2 lights. sight  
Sizes, full \_\_\_\_\_  
Ventilators None (says Edgar Martin). Set by \_\_\_\_\_  
Position in Church Last window on S.E. side near entrance end.  
Height from floor 9 feet. Protec- Groove Stone  
tion Glass Rabbet Wood  
Points of compass East by South.  
Quality of light \_\_\_\_\_  
Inscription \_\_\_\_\_  
1885 In Loving Memory of Elizabeth Esther Hormel 1938  
Design wanted \_\_\_\_\_ Staging \_\_\_\_\_  
Shipping address \_\_\_\_\_ Blue-prints \_\_\_\_\_  
Received \_\_\_\_\_  
Bill to \_\_\_\_\_ Templets Edgar Martin.  
Photos of Cartoons Mailed \_\_\_\_\_  
General Information We are to make a sketch - Saint Mary and Saint Elizabeth,  
with words from Magnificat or Benedicite, of Saint Elizabeth.  
(See photographs of northeast aisle window placed in 1923, and three-lancet  
canopy window placed in 1915.)  
\_\_\_\_\_  
\_\_\_\_\_  
\_\_\_\_\_  
\_\_\_\_\_  
\_\_\_\_\_

For addresses of those to be notified as window progresses, see other side.

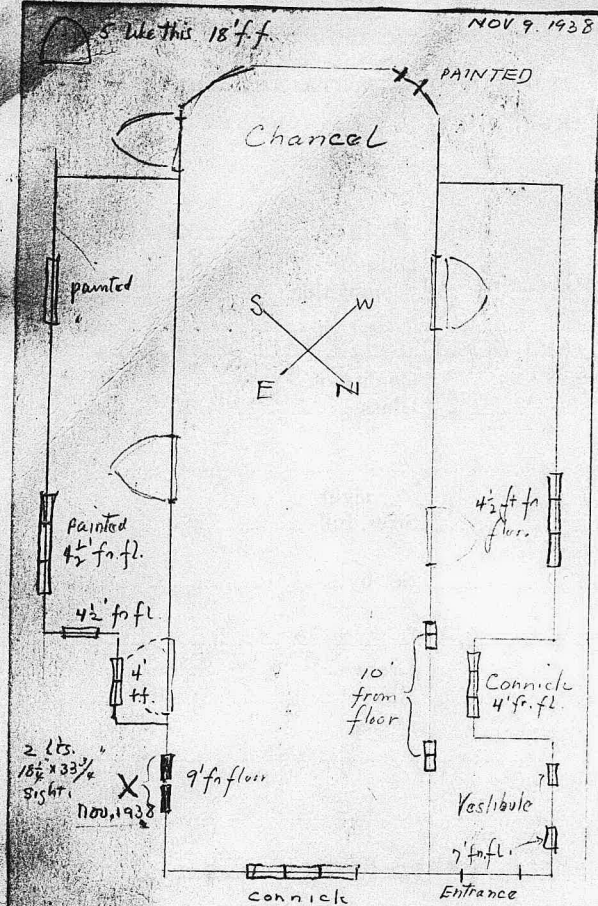

West Roxbury - Emmanuel Church

Blessed Virgin  
 Saint Elizabeth's  
 Luke 1:42), and  
 The Lord"

and blue,  
 contemplation,  
 under one that  
 distinguished by an  
 out-of-doors.  
 , messengers of

th is the Winged  
 e descending Dove

Saint Joseph with  
 be developed in  
 1 lines of the

for the

This window is devoted to Saint Elizabeth and the Blessed Virgin Mary in a design that symbolizes The Visitation through Saint Elizabeth's joyful greetings: "Blessed art thou among women" (Saint Luke 1:42), and the first words of The Magnificat: "My soul doth magnify The Lord" (Saint Luke 1:46).

The significant central figures in garments of ruby and blue, traditionally identified with divine love and heavenly contemplation, are represented under canopies. Saint Elizabeth stands under one that suggests an interior, while the Blessed Virgin is distinguished by an arrangement of conventional cloud forms to signify the out-of-doors.

Both canopy forms are supported by kneeling angels, messengers of heavenly approval.

In the field of the panel devoted to Saint Elizabeth is the Winged Ox of Saint Luke, balanced in the companion panel by the descending Dove of the Holy Spirit.

Smaller figures of Saint Zacharias with censer and Saint Joseph with his flowering staff further enrich the field that is to be developed in luminous whites and cool tints to emphasize the vertical lines of the design.

Across the base of each panel a space is provided for the memorial inscription.

