

CHARLES J. CONNICK : DESIGNER AND WORKER IN STAINED AND
LEADED GLASS : NINE HARCOURT STREET, BOSTON, MASSACHUSETTS

City or Town Somerville, State Mass. No. 1954 Dedication, May 30, 1937.
 Church Clarendon Hill Presbyterian Church. Date of Completion June 1, 1937.
 Donor and The Women's Group. The Alpha Guild,
 Address Mrs. Calvin MacLeod, 36 Orchard Street, Cambridge, Mass. 7.00 0.118
Mrs. Dowe - Som. 2095-W. Quality of Glass \$125.00* f.o.b. Somerville
 Architect _____ Denomination Presbyterian.
 and Minister Rev. Alexander Mitchell, 50 Curtis St. Somerville.
 Footage 10 1/2 feet. sight Sizes, full _____
 Ventilators None Set by _____
 Center opening of the three-light group. _____
 Position in Church Southwest nave opposite chancel.
 Height from floor 4 feet Protec- Groove ~~Stucco~~ Wood sash we
 tion Glass _____ Rabbet _____ supply.**
 Points of compass _____
 Quality of light Southwest.
 Inscription None.
 Design wanted October 13, 1936. Staging _____
 Shipping address _____ Blue-prints _____
 Received _____
 Bill to _____ Templets _____

Photos of Cartoons Mailed _____
 *f.o.b. Somerville, Mass, at The Clarendon Hill Pres. Church.
 General Information ~~*We have planned this sketch at a cost of \$100 without the
 little angel figure as a central color symbol enrichment. I think this price
 could include the new wooden sash, if you (Mrs. MacLeod) can arrange to have
 someone there at the church install it. We would place the glass in the
 sash and send it out to you already to be set in the frame.
 *We could include the little angel panel at an additional cost of \$25.
 if it were made with the window.~~

**A new wooden sash is to be furnished by me, sizes for which are to be
 supplied by the Alpha Guild. The sash will be installed in the church by
 the Alpha Guild.

For addresses of those to be notified as window progresses, see other side.

Leqmere car, then Clarendon Mill Car to Teele Square.
Curtis Street near there.

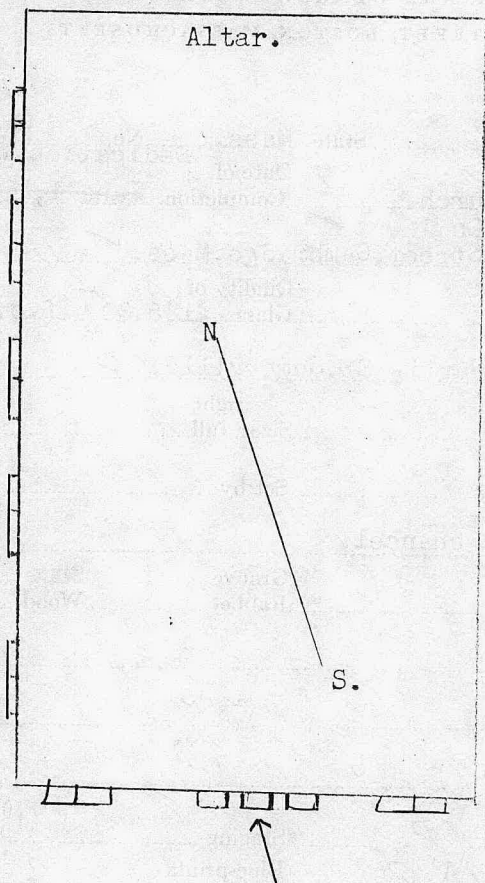

The window being considered is the center one of a group of 3 windows under a big five lancet opalescent window of a very simple type, made in 1926-7 by Spence, - very simple fields of rather heavy amber opalescent, ornament in heavy blue opalescent, some maroon, a central symbol of a cross and crown, alpha and omega, at the top, Monograms of Christ.

These three windows face southwest. There are five 2-panel and transom groups on the northwest side, nothing on the opposite side and nothing in the chancel, two more of these same groups on the southwest - one on either side of the central group of three small ones.

All in wooden frames and wooden muntins.

The ladies who came in liked a background something like the Waco darker sample, w a wide amber grisaille border, possibly a narrow blue line, with red blocks outside of that. A few little spots of color throughout the field, and a medallion in the upper part - an adoring angel, keeping in mind the same plan for the other two side windows, to have angels of Praise and Prayer.