

Make card

CHARLES J. CONNICK : DESIGNER AND WORKER IN STAINED AND LEADED GLASS : NINE HARCOURT STREET, BOSTON, MASSACHUSETTS

City or Town Pittsburgh State Pa. No. 1921

Church University of Pittsburgh Foster Shrine Date of Completion Nov. 3, 1936. (We are not held to this on account of the delays). 10/1/36.

Donor and Address ..... Quality of Glass \$8,550.00

Architect ..... Denomination and Minister .....

Footage See below. Sight Sizes, full .....

Mr. Weber said that we could use the ordinary extruded bronze bars in the shrine and the steel ventilators could be changed later on if they wanted Bottom vents in 6 shrine windows.

Position in Church Stephen Foster Shrine.

Height from floor 13' (six). Protection Glass ..... Groove Rabbet ..... Hunt says Stone metal is Wood steel.

Points of compass ..... Quality of light See below.

Inscription .....

Design wanted ..... Staging .....

Shipping address ..... Blue-prints Received .....

Bill to ..... Templets by James Hunt.

Photos of Cartoons Mailed .....

General Information Six traceried windows in the hexagon unit, containing painted borders and backgrounds of tinted glass as selected, and twelve medallions subjects as decided. (Footage: 59 feet in four and 47 feet in two. Total 330'. (Exposure: 1 North; 1 N.E.; 1 S.E.; 1 S; 1 S.W; 1 N.W.)

Five Corridor Windows — oblong medallions, subjects as decided. (Footage 6 feet each - 30 feet total.)

Eight Windows, Type B. (Footage 8 feet each, total 64 feet)

Five Windows, Type A. (Footage 6 1/2 feet each - total 32 1/2'

Two windows in the Main Entrance Hall, each in three lights with tracery, leaded in water-white slabs (Footage 33 feet each group - total 66 feet.)

IMPORTANT: "The Flute Player is to be a young boy and not a man."

For addresses of those to be notified as window progresses, see other side.

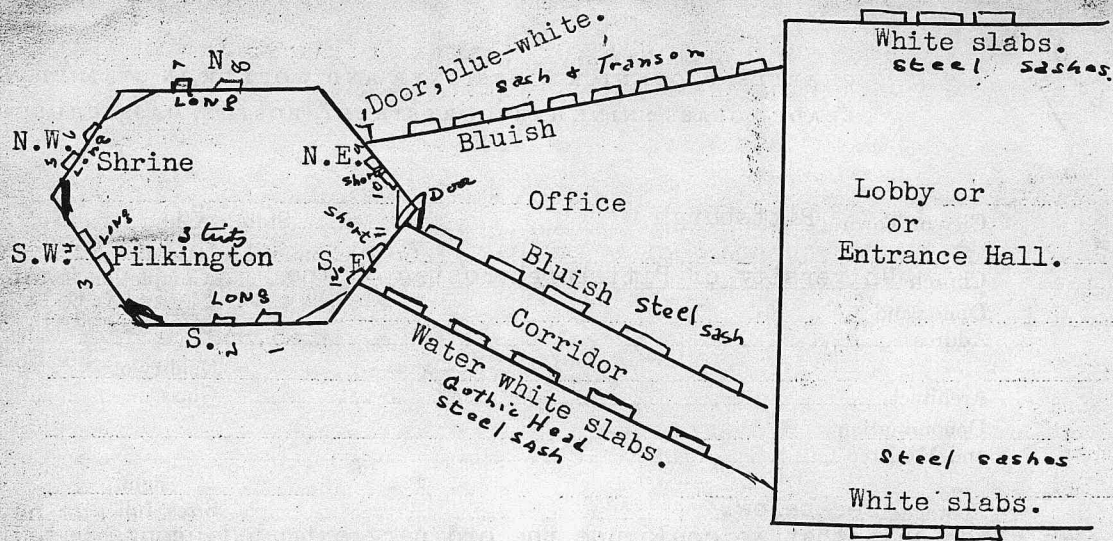

October 1, 1936. Note made while Mr. Weber and Mr. Klimcheck were at the studio. Glass #508 (bluish tint) is to be used in the inside windows in the corridor; and in the outside office windows.

In the Type C. Windows and the two windows in the Lobby are to have water-white slabs.

The large windows are to be in three tints.

#### Large Windows

"Open Thy Lattice, Love"

"Old Folks at Home"

"Oh! Susanna"

"Come Where My Love Lies Dreaming".

"Ah, May the Red Rose Live Alway"

"Old Black Joe".

"Jeanie with the Light Brown Hair".

"My Old Kentucky Home, Good Night."

"Gwine to Run All Night" (Campdown Races).

"Willie, We Have Missed You."

"The Glendy Burke" (River Steamboat).

"Massa's in de Cold Ground".

#### Corridor Windows (Left to Right).

"Old Dog Tray".

(A setter dog that was a constant companion to Stephen).

"Nelly Bly"

(Bring de broom along, sweep de kitchen clean).

"Boy with Flute" (Centre)

(The Flute Player is to be a young boy, not a man).

"Gentle Annie"

(A sweet young girl who met with an untimely death.)

"Uncle Ned"

(A decrepit old Negro with no wool on his head.)

#### Footage notation:

5 windows	6 feet each	- 30'
5 "	6½ " "	- 32 1/2'
8 "	8 " "	64'
		126½ feet
2 groups	33' "	66 Entrance hall
		192½ feet.



Note from Palchanis - (in Mr. Weber June 17, 1936).  
 There are two floors. Fourth floor is the one we figured. Darlington has 3 lancet window. Do not figure corner rooms. Fifth floor is same as fourth, with five lancet in place of three over Darlington.

5th floor:

20 groups 59' each	1000.
8 windows 30' each	240.
2 groups 66' each	132.
1 group 90'	90.
	<hr/>
	1462. ft.

4th floor:

20 groups 50' each	1000.
8 windows 30' each	240.
2 groups 66' each	132.
1 group 70'	70.
	<hr/>
	1442 ft.

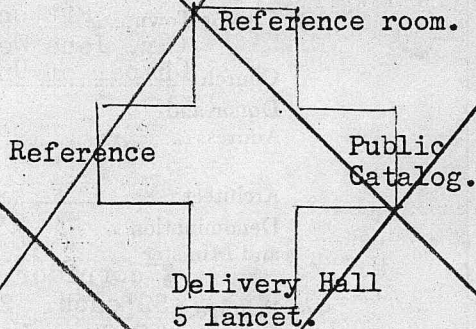

~~1462~~  
~~1442~~  
~~2904 ft.~~  
~~\$25.~~  
~~\$66,792.00~~

July 31, 1936, sent Mr. Weber 4 samples of glass known as "Colonial Antique". "My idea is to use in the clear glass windows for the Shrine, the four tints I am sending you, although emphasizing shade #2." (Sent Shades #2, 5, 7, 12.)

5 windows - 6 feet each	= 30'	@ \$13.50 =	405
5 " 6 1/2 feet "	= 32 1/2'	@ " =	488.75
8 " 8 feet "	= 64'	@ " =	864.00
	<hr/>		
	126 1/2 feet.		\$7299.75
2 groups 33 feet each	<hr/>		
	66		
	<hr/>		
	192 1/2		

Delivery Hall

Copy of contract. 22

August 13, 1936.

The University of Pittsburgh,

Pittsburgh, Pennsylvania.

Eight thousand, five hundred fifty . . . . .

8,550.00

Pittsburgh, Pennsylvania,

in the University of Pittsburgh, Stephen Foster Shrine,

November 3, 1936.

Six traceried windows in the hexagon unit, containing painted borders and backgrounds of tinted glass as selected, and twelve medallions in subjects as decided.  
 Corridor Windows - oblong medallions

The University of Pittsburgh,

Pittsburgh, Pennsylvania.

Eight thousand, five hundred fifty . . . . .

8,550.00

Pittsburgh, Pennsylvania,

In the University of Pittsburgh, Stephen Foster Shrine,

November 3, 1936.

✓ Six traceried windows in the hexagon unit, containing painted borders and backgrounds of tinted glass as selected, and twelve medallions in subjects as decided.

Corridor Windows - oblong medallions, subjects as decided.

Eight Windows, Type B, leaded in ~~water-white slabs~~ *(Outside office doors)*

Five Windows, Type A, leaded in water-white slabs, *(inside doors of the corridors)*

Two windows in the Main Entrance Hall, each in three lights with tracery, leaded in water-white slabs.

Large Windows

"Open Thy Lattice, Love"

"Jeanie with the Light Brown Hair."

"Old Folks at Home"

"My Old Kentucky Home, Good Night."

"Oh! Susanna"

"Gwine to Run All Night" (Campdown Races).

"Come Where My Love Lies Dreaming".

"Willie, We Have Missed You."

"Ah, May the Red Rose Live Alway"

"The Glendy Burke" (River Steamboat)

"Old Black Joe".

"Massa's in de Cold Ground".

Corridor Windows (Left to Right).

"Old Dog Tray"

(A setter dog that was a constant companion to Stephen)  
(Bring de broom along, sweep de kitchen clean).

"Nelly Bly"

"Boy with Flute" (Centre)

"Gentle Annie"

(A sweet young girl who met with an untimely death.)

"Uncle Ned"

(A decrepit old Negro with no wool on his head.)

Aug. 13, 1936.  
We must not have anything in the tints of those windows that will stand out at all. They want to be very slight. The big windows only are to be in tints. The corridor windows and all the other windows are to be the water white slabs.  
CJC.