

St. Mary's Church Hyde Park Cincinnati Ohio
 John Comes 685

Letter From Father Hyndes to John T. Comes, August 1.

Connick has been here, and he ought to know just what we want; I rather liked the design of what he submitted, it was only the dullness of the colors I objected to, the greyness of the walls would call for much color, and I would imagine a light window would hardly give us the effect needed. Don't you think that the large window over the door and altar will ~~give us the~~ ~~light needed~~ help light up the church, even though side windows are heavy? I don't quite like the idea of artificial light in day time, -his Brockton church did not need it, it seemed to me. What we want of Connick is more color than his sample here. With this explanation he could go on with the windows in the manner he suggests. The clerestory and eight side windows.

Subjects for aisle windows:

St. Agnes; Cecilia, Elizabeth of Hungary, St. Monica,

Edward Confessor, (Eng), Louis France, Boniface, (Ger) Patrick, (Ireland.)

Connick must be given to understand that his sample was too dark, cold, colorless. We want it brighter, warmer, and more colorful. Connick must have color; his Brockton windows had much more by far than his sample. Please impress this on him.

Bottom of windows 6 or 8 feet from floor

St. Mary's
 Cincinnati
 8 Aisle windows
 2-2 x 11 ft.
 24 ft.
 3
 87 ft.
 7 1/2
 6
 87 ft. 52 2
 150
 672 670
 Munich W.

8 aisle windows

The 4 women on W. side -
 (these made somewhat lighter)

The 4 male figures on S. side -

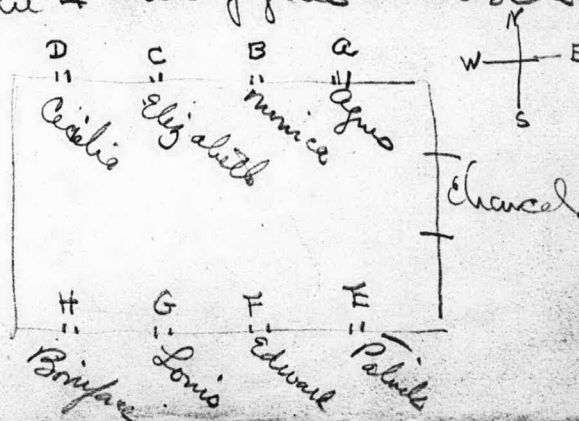

Grayscale in clerestory to be a little lighter than aisle W.

Father Agnes letter Sept 4th: There will be no
insertion on aisle windows!!

Oct 22-1917

Hordman gave

Connors Personally

a price of 2000

per piece for

fining and gleying

& elementary work

Oct 22

Price for bracing

from Beaumont Wells

\$2.00 per foot

St Marys Church
 Hyde Park Cincinnati, O.
 John T. Comes

Rectory Window

Comes

685-

- 26" x 131" = 23-7-10 x 3 = 71
- 7" x 25" = 1-2-7 x 4 = 5
- 11" x 17" = 1-3-7 x 2 = 3
- 26" x 30" = 5-5-0 x 1 = 5
- 6" x 22" = 0-11-0 x 2 = 2
- 3" x 6" = 0-1-6 x 2 = 2

8 windows

89 gft

Trays

- 26" x 113" = 20-4-10 (x 2) = 41
- 26" x 127" = 22-11-2 (x 2) = 46
- 10" x 34" = 2-4-4 (x 4) = 10
- 29" x 31" = 6-2-11 x (1) = 7
- 6" x 10" = 0-5-0 x (2) = 1
- 8" x 21" = 1-2-0 x (2) = 3

108 gft

Clustering

- 5" x 8" x (2) = 0-8-0
- 30" x 66" x (2) = 27-6-0
- 16" x 9" x (4) = 4-0-0
- 17" x 7" x (4) = 3-3-8

8 windows

36 gft