

Nº 5002

Place Kansas City, Missouri

Building Saint Luke's Hospital Chapel

Date of Completion August 1, 1968
Price: \$1,250.00

Persons Interested Right Rev. E. R. Welles, (Bishop of West Missouri) (In 1965 Annual Also, - President of the Board of Directors of St. Luke's Hospital, K.C., Mo.)

Minister Denomination

Architect *Loss 9/18.97 = .735/p.*

Vents Yes, in place

Position in Church West side of chapel, nearest altar

Height from floor Protection Glass Groove Rabbet Metal Stone Wood

Exposure West Footage 21½ feet @ \$74.41

Memorial Inscription None

"citation" ***

Text

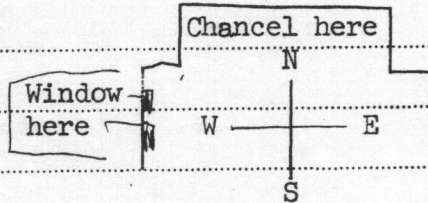

Design wanted Staging

Templates Blueprints

General Information "Gethsemane"

Our designers wanted to study it at once and have prepared a rough color sketch to share with you. This suggests Our Lord kneeling in prayer at the rock, while the three apostles sleep or also kneel in the attitude of prayer.

Rays of divine light descend from the vision of the angel with the cup. The angel could be omitted, having only the cup, or it could be eliminated and the trees extended into the space.

The three crosses of Calvary are suggested in the tracery opening.

** FATHER, NOT WHAT I WANT Large-lettered words to be put at the
BUT WHAT YOU WANT base of the lancets