

Wickenburg, Arizona.

No 4675

Place Canton, Massachusetts

Building Saint Alban's Episcopal Church,

St. John the Evangelist Church.

Date of Completion July 1, 1964,

\$700 ea (\$87.50) f.o.b.

Persons Interested Donald Ralph Kerr, Wickenburg,  
Arizona, Senior Warden.

Price: \$725.00 f.o.b. Wickenburg  
(\$90.62).

*Prof'd 9 7/8 127.51*

Minister.....

Denomination Episcopal.

Architect.....

Vents.....

Position in Church Windows in chancel - one each side.

Height from floor.....

Protection Glass.....

Groove Rabbet.....

3/4" Metal steel casement  
Stone III Wood IX

Exposure ~~SEASWSEASW~~ S. Alban. Diocese of Arizona.  
1 south; 1 north.

Footage 8 feet each.

Inscription On window bearing seal of Bishop of Arizona, -

"To the Glory of God and

In loving memory of Louise Dodge Kerr!"

On window bearing the seal of Saint Alban, -

"To the Glory of God and

In loving memory of William Ralph Kerr, Jr."

Design wanted soon.

SIZES letter of June 16 '64 46 3/8 X 24 3/8 sight size 45 1/4 x 23 1/4 groove 3/4"

Templates.....

Blueprints.....

General Information See photograph of interior of church.

"We feel that the use of symbolic seals surrounded by ... "foliated grisaille",  
as in the photos of St. Gabriel's Church, Marion, Mass., or ... the Chapel  
vestibule of First Methodist Church, Evanston, would be suitable. In any  
event, ... we would like ... the theme of symbols set in windows in which the  
pieces of glass were relatively small and rich in color with a sort of  
pattern or design surrounding the symbols."

Window on Gospel side to have Seal of Diocese of Arizona.

Window on Epistle side to have Seal of St. Alban.

See illustrations and floor plan.



**JAMES (THE LESSER)**

Represented by a saw, since it is said his body was sawn asunder after a horrible martyrdom.

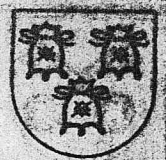

**MATTHEW, AS AN APOSTLE**

Is symbolized by three purses referring to his original calling as a tax collector.



**THOMAS**

A carpenter's square and a spear, because this apostle is said to have built a church with his own hands, in India. Later, he was persecuted there and was killed with a spear by a pagan priest.



**BARTHOLOMEW**

This apostle is said to have been flayed alive, hence he is usually represented by three flaying knives.



**SIMON THE ZEALOT**

This symbol is a book upon which rests a fish, because through the power of the Gospel Simon became a great fisher of men.



**MATTHIAS**

Chosen to take the place of Judas, he is symbolized by an open Bible and double bladed battle-axe. He is said to have been beheaded after his missionary work.



**THE TWELVE APOSTLES**

The apostles have been symbolized as a group as well as individually. In one place, twelve doves are used; in another, twelve men are shown, each with a sheep. Some very early carvings represent the apostles as twelve sheep.

# SYMBOLS OF THE APOSTLES

## PETER

The crossed keys recall Peter's confession and our Lord's gift to him of the keys of the kingdom. See Matt. 16:18, 19.



## ANDREW

Tradition says that while Andrew was preaching in Greece he was put to death on a cross of this type.



## JAMES (THE GREATER)

The scallop shell is the symbol of pilgrimage and stands for this apostle's zeal and missionary spirit.



## JOHN, AS AN APOSTLE

Early writers state that John once drank from a poisoned chalice and was unharmed. Jesus once said that John should drink of His cup.



## PHILIP

A cross and two loaves of bread; because of Philip's remark when Jesus fed the multitude. (John 6:7)



## JUDE

This apostle traveled far on missionary journeys in company with Simon, according to tradition, hence the ship.



## THE TWELVE APOSTLES

The apostles have been symbolized as a group as well as individually. In one place, twelve doves are used; in another, twelve men are shown, each with a sheep. Some very early carvings represent the apostles as twelve sheep.



# ST ALBAN'S EPISCOPAL CHURCH

WICKENBURG, ARIZONA

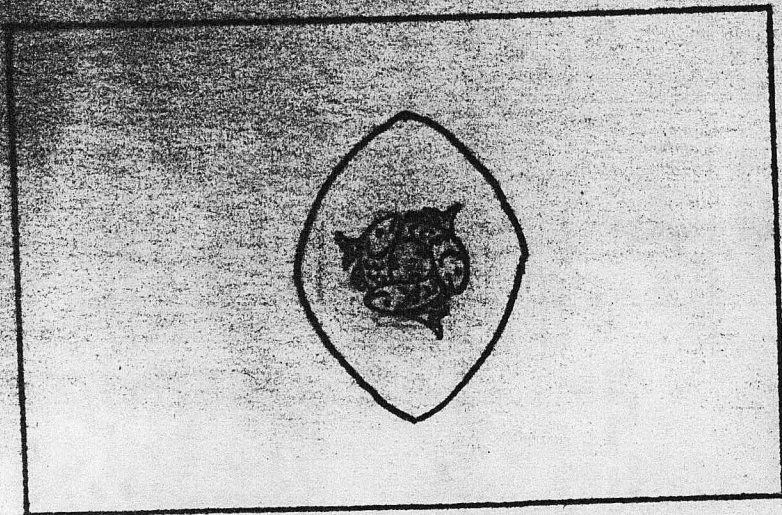

NAVE WINDOWS # 1 and 6

SYMBOL OF THE TRINITY

and

SYMBOL OF 7 GIFTS OF HOLY SPIRIT



19' each

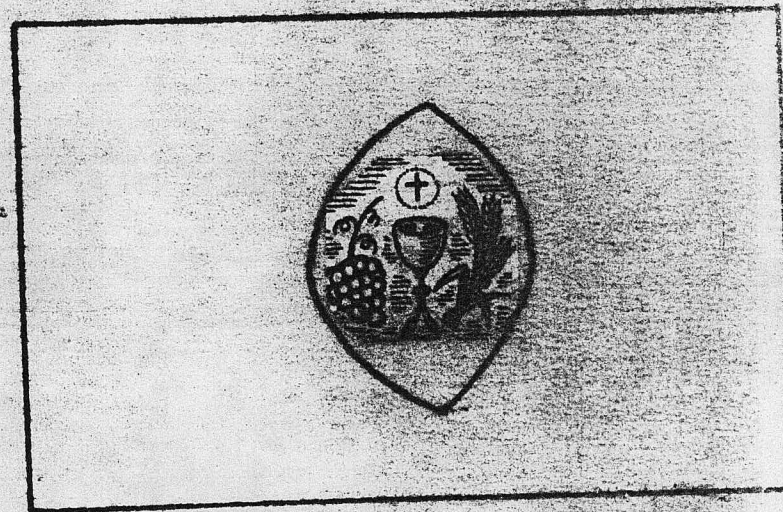

NAVE WINDOWS # 5 and 10

SYMBOL OF HOLY EUCHARIST

and

SYMBOL OF HOLY BAPTISM



ST ALBAN'S EPISCOPAL CHURCH



CHANCEL - GOSPEL SIDE  
SEAL OF DIOCESE OF ARIZONA 23" x 46 1/2"

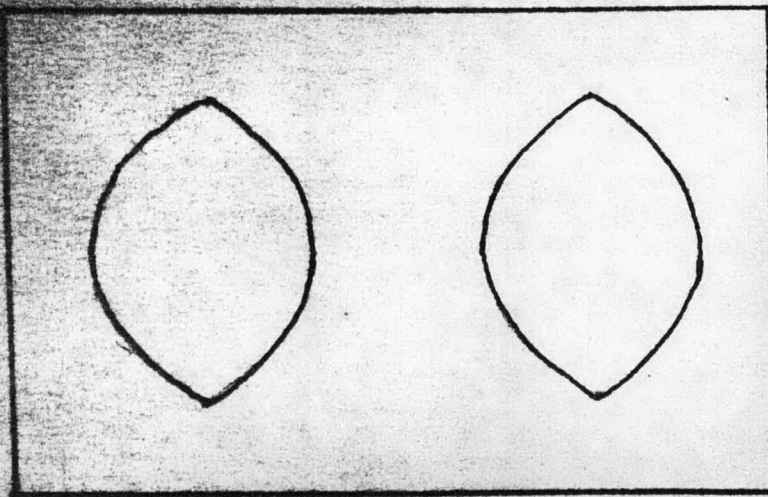

NAVE WINDOWS # 2, 3, 4, 7, 8, 9  
SEALS OF 12 APOSTLES  
37 1/2" x 46 1/2"

8' each

12' each

WICKENBURG, ARIZONA



CHANCEL - EPISTLE SIDE  
SEAL OF ST. ALBAN 23" x 46 1/2"

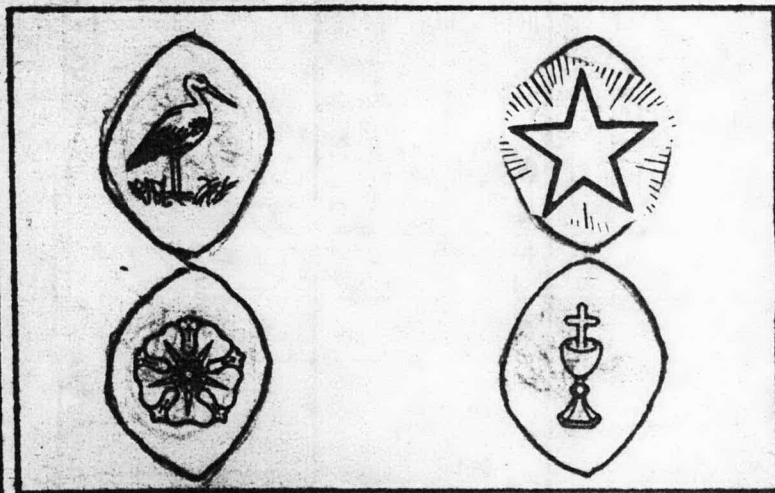

NAVE WINDOWS # 1 and 6 Alternate  
EIGHT SEASONS OF YEAR  
37 1/2" x 46 1/2"

BESIDE ENTRANCE DOOR  
2 WINDOWS 16" x 91" 10' each

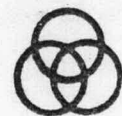

WICKENBURG, ARIZONA  
ST. ALBAN'S EPISCOPAL CHURCH

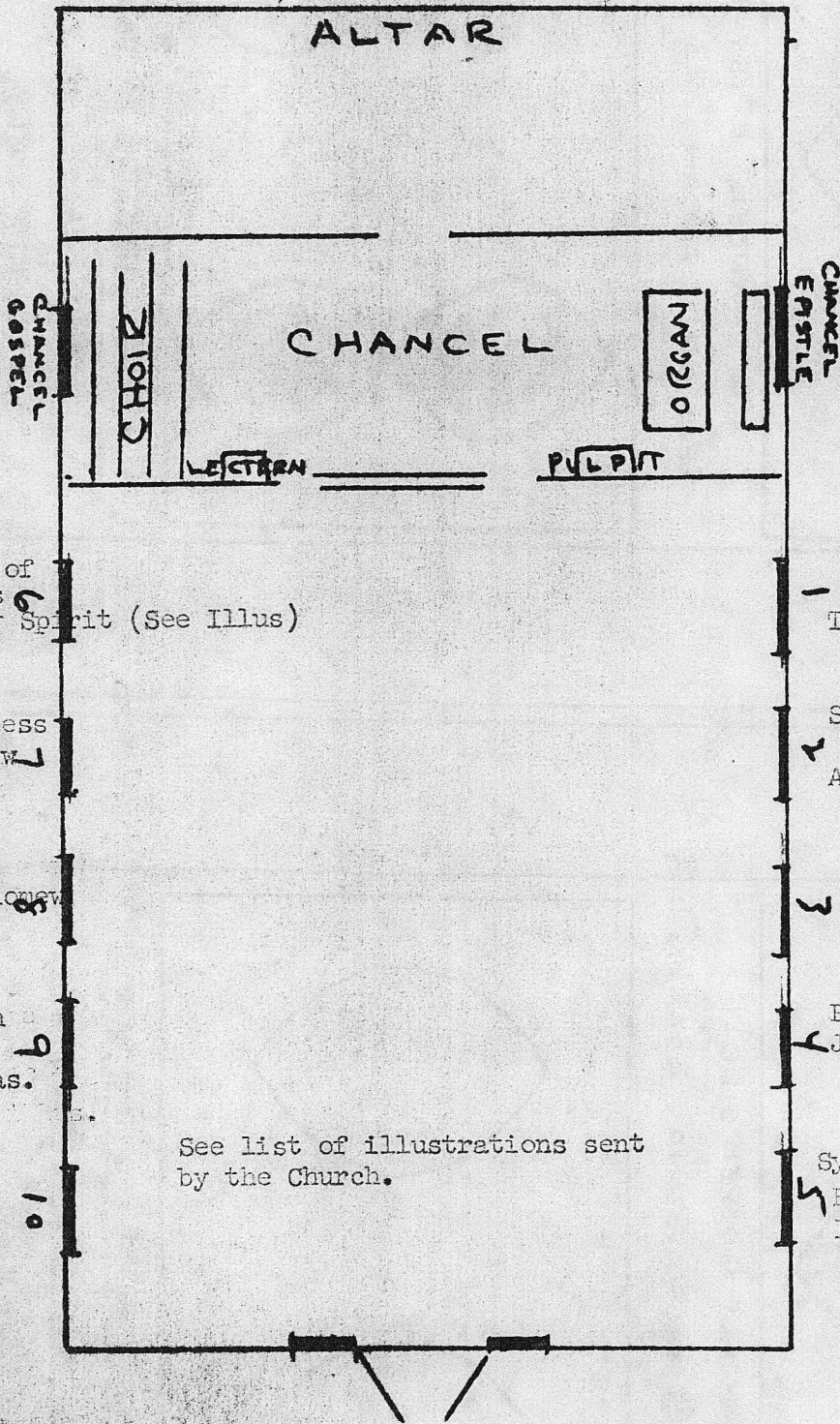

Symbol of 7 Gifts of Holy Spirit (See Illus) 6

James, Less Matthew 7

Thomas, Bartholomew 8

Simon Matthias. 9

Symbol of Holy Baptism 10

See list of illustrations sent by the Church.

1 Symbol of The Trinity (3 Fishes)

Symbols: 2 Peter Andrew

3 James, Greater John

7 Philip Jude

5 Symbol of Holy Eucharist - see Illus.

*as the actual*

The chancel windows would be treated in much the same manner. The more pointed aureole shape could be used if you prefer, but we rather like the oval.

I think we can develop the windows in this manner for seven hundred and twenty-five dollars each, delivered to the church.

Although the chancel windows are somewhat smaller, the involved detail of their seals would keep the cost about the same. The panels beside the door could be a little less, with one significant Christian symbol as the dominant theme in each.

As planned, one is devoted to the Seal of the Diocese. The colors indicated in the print you sent are not very rich. I wonder if we could use clearer and purer tones especially for the blues; and could not the central cross be richer gold?

The other features the shield of Saint Alban. We have added the martyr's crown and scrolls to harmonize with the opposite one. Of course these can be omitted if you prefer.

As we said in our earlier message, we propose to make these first ones for seven hundred dollars each in spite of the complexity of the shields.

To be entirely safe, it would be well to again verify the exact sizes, - the full or actual glass size and the sight or daylight size, with the width and depth of the rebate or groove.