

Sketch made under #4338

Church is hard to find. It is east of Plymouth.

No 4747

Place Grand Rapids, Michigan.
Building Grace Episcopal Church, 1815 Hall Street Southeast, Grand Rapids 6, Michigan.
Date of Completion July 1, 1964.
Persons Interested Tel. CH 1-4631 Price: \$1500 each (\$41.66)

Handwritten note: Paid 8/10/70 23.61

The Reverend Donald V. Carey, Rector.
Minister Home: 2550 Maplewood St. Tel. GL 2-1148 Denomination Episcopal.

Architect Schulte.

Vents Fall-in vents in the windows 5/4/60
Position in Church Nave: West aisle window nearest chancel devoted to Simon and Matthias.

Height from floor About 4' Protection Glass Groove Rabbet Metal Stone Wood

Exposure West Footage 36 feet each pair.

Inscription None.

Design wanted X Staging

Templates Blueprints

General Information West nave window, middle pair, Saint Matthew and St. Thomas. West nave, nearest chapel, Simon and Matthias.

Set by the Grand Rapids Art Glass Company

The purses are the principal symbol for Saint Matthew, in reference to his original calling, with the halberd above, and his Gospel below. Saint Thomas is represented by the square, spear and arrows, the leather girdle and three stones, and the scroll inscribed with the significant text, - "My Lord and my God.

Saint Simon has the book upon which lies a fish, - the fisher of men through the power of the Gospel; and again, the fish and boat hook, the oars and battle-axe. THE SYMBOL OF JUDAS - THE BAG OF COINS ON A BLACK CIRCLE AND A NOOSE IS NEAR THE BASE OF THIS PANEL.

The group is completed with the symbols of Saint Matthias, - the open Bible and a double battle-axe, the sword and lance, and again, three stones.

The windows are designed in a very light palette and simple but well

composed leading. Suggestions of the grapevine and grapes through the fields and border suggest the unity and fruitfulness of the Church, and recall Our Lord's significant words, - "I am the vine, ye are the branches." The principal medallions alternate in cool and warm colors, blue and ruby.

SEE COLOR PLATES OF THE WINDOWS IN PLACE.  
BE SURE NOT TO SIGN THESE WINDOWS.

The pastor wrote for the earlier windows: "...all the windows should be kept light - windows you can see through - should not become "busy". Likes glass of a "swirly"..."

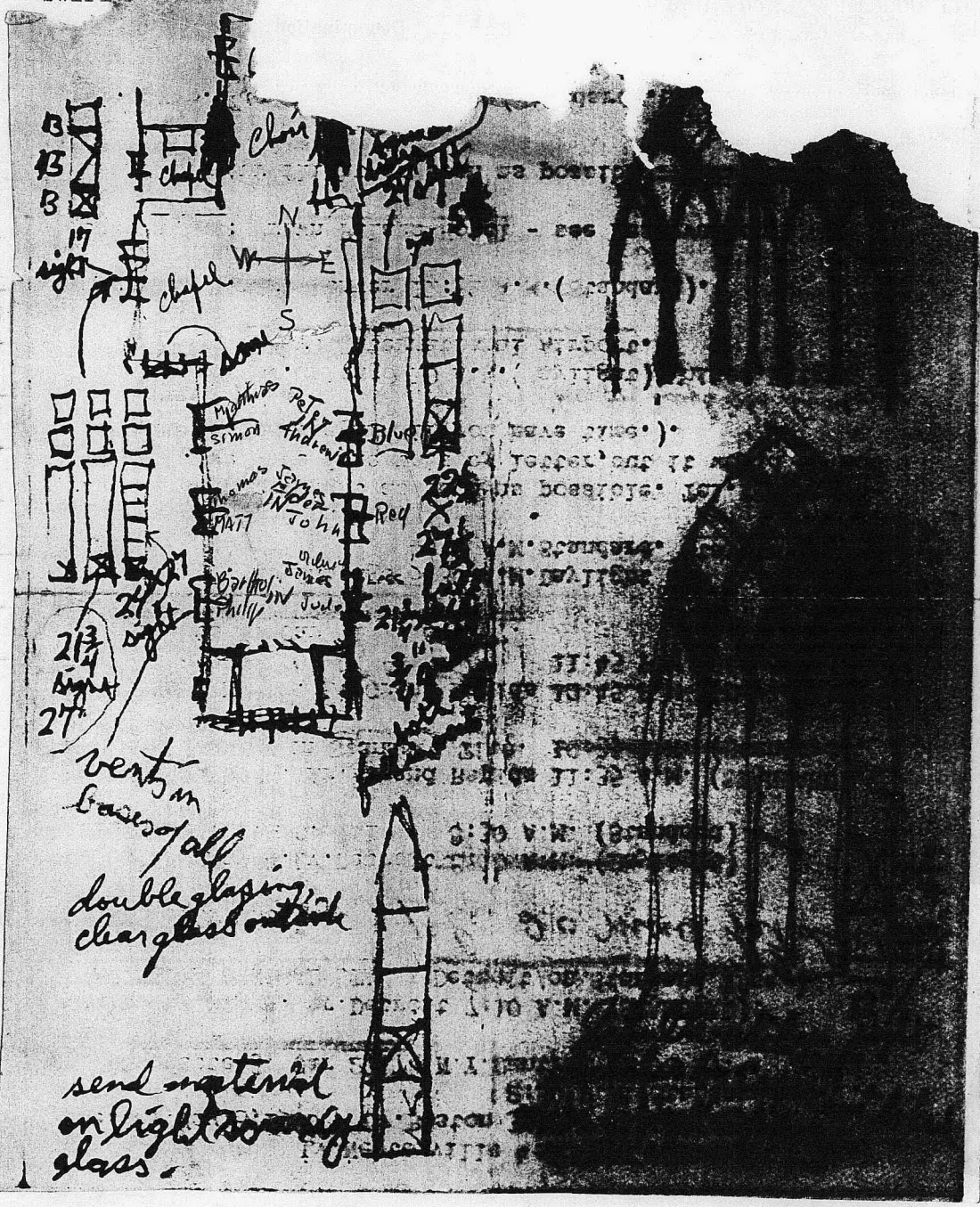

vents in bases of all double glazing, clear glass outside

send material on light so many glass

Note: Philip & Bartholomew sent but perhaps not placed. There are red medallions. In case to divide on which side of wall of nave. 5/31/63