

Bus 69 to Church of Redeemer. Bus is only 1 block from Netherlands Hotel -
25¢ fare

Place Cincinnati, Ohio.

No 4359

Building Church of the Redeemer, 2944 Erie,
tel: 321-6700

Date of Completion *Sum of Wds 4/5/6
"us, after adu given"
4/8/61*

Persons Interested

Price: \$4000 (\$51.28)

Incl. removal of bar \$4,050.00
(\$50.00 added for removal of bars
in center lancet)

Minister The Rev. Henry W. Sherrill.

Denomination Episcopal.

Architect Charles Frederick Cellarius.

Low. cost 8/10/60 \$353.42.

Vents In Place.

Position in Church Window over entrance. Balcony window

Height from floor Protection Glass Groove Rabbet Metal Stone Wood Metal frames.

Exposure South. Will probably be lighted
artificially for viewing from outside. Footage 78 feet.

Inscription

Design wanted ~~soon as possible. Before end of July.~~ January 22, 1961.

Staging

Templates

Blueprints

General Information The entire theme of the windows to be The Redemption through Christ. This window to be devoted to The Ascension, with Angels.

To have simple fields, with colorful figures - and medallions - to be quite simple and clear.

They like the Laconia windows especially, and also very much liked the Joseph window in Christ Church, Quincy; the Puyallup windows, and the Edgewood Congregational Church windows, Cranston, although one lady did not like the wide borders.

All the windows have metal frames. All the glass is set from the outside in putty. Keep the Tee Bars in the front window. This front window has T-bar divisions about 7/8" wide. The vent frames are 2 inches wide.

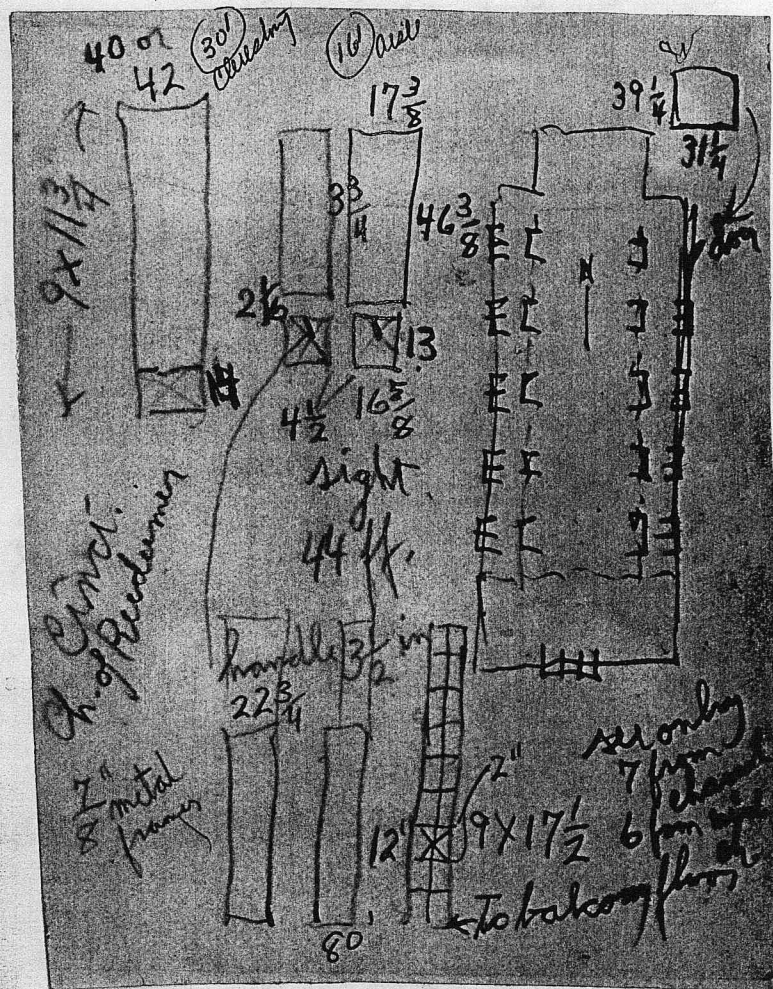

We have in mind a very light and brilliant palette for all the windows, to admit an abundance of colorful illumination.

There is ample opportunity for symbols for local significance, - industry, arts, culture and achievements, in minor positions through the fields.

Changes to be made in design:

This is planned to be a memorial for the son of Mes. Tangeman, who was killed in service, and also for other members of the Parish. Dr. Sherrill has in mind Stephen's vision of the Ascending Christ. He should be represented in the lower central panel in his Martyrdom, and representations of the branches of the four armed Services in the panels at either side.

The figure of Christ not with hands down, but more in the attitude of the Laconia window.

Include some other symbols implying a War Memorial.

We have kept in mind the over-all theme of the Redemption through Christ.

The balcony window over the entrance is designed within the present steel construction, providing sturdy support, geometric and rhythmic foundation. The same is true of the clerestory windows. Both structures were beautifully adapted to the development of the enrichment, and even if all the windows are not undertaken at the same time their basic character will not be disturbed.

As planned, the balcony window is devoted to the Ascension. The radiant figure of Christ is placed at the center with attendant angels at either side. The Apostles are grouped below.

Related symbols are designed through the fields, - the pelican feeding its young, ancient symbol of Our Lord's Sacrifice; the peacock, traditional symbol of Immortality; with the Alpha and Omega below.

A space is designed at the base for a memorial inscription or a significant text.

See changes above