

11/650
1961

Card made
3/23

500.00
1,000.00
45.45
see also letter of 9/24/61

Place Grand Rapids, Michigan.
Building Saint John's United Church of Christ,
1935 Lake Michigan Drive, N.W. Tel. GL 6-5381. Date of Completion April 1, 1963, for 2 S. p.
Persons Interested Price \$650 each panel (\$59.09) nearest chancel.

2600.00 Less 1223.92 = 47 %

Minister The Reverend Herbert W. Barten. Denomination Evangelical and Reformed.
Architect Roger Allen & Associates, Architects, 1126 McKay Tower, Grand Rapids 2, Michigan. Tel. GL 6-1527. (Paul Flanagan.)

Vents In place
Position in Church Aisle windows. (9 pairs, five on one side and four on the other.)
(4 pairs Epistle side, 5 pairs Gospel side) Metal Metal casemen

Height from floor 5 feet. Protection Glass. Groove Stone Rabbet Wood

Exposure 4 pairs South; 5 pairs north. Footage 22 feet each pair.

Inscription None 4/26/61.

15
115

Design wanted soon. Before August 20, 1961. Staging Yes
Wrote Advance Glass Co., P.O. Box 3157, Tulsa, Mr. Don Tracy, for these.
Templates Blueprints Yes

General Information These windows should be lighter than the chancel for they are quite small for the size of the church. They get good strong light, but they still should have good strong color in figures and symbols.

The pastor tentatively mentioned for one tier of the aisle windows, the bottom tier, figures and symbols of leaders, Abraham, Moses, etc.

See O.E.S. measurements on report of 3/9/61.
The pastor wrote, Feb. 14, 1961 - "...Christian Life" series in the eight windows on one side of the nave, and a "Church Year" series for the ten windows on the other side of the nave. (not definite)

These to harmonize with the chancel window, although in considerably different manner.

Make designs for The Nativity, The Last Supper, The Resurrection ("We would like the second and third panels from the top to be accented.") These will be on the north side.

see suggestions in letter of 5/31/61 also 9/6/61

The side windows are designed in very luminous tints, with comparatively simple leaded pattern, accented with full color subject compositions and symbols.

We have suggested the ^{see new scheme} Nativity, in a double window. The Virgin Mary and Saint Joseph are represented with the Christ Child in the manger, and the ox and ass looking on. Above is the Star of Bethlehem with descending rays of Divine light. Below is the Mystic Rose of the Virgin Mary.

Although it will actually take another position in the series, we have indicated the Last Supper on the same sketch. The Apostles are grouped around the table with Our Lord at the head, His hand raised in blessing. The cup is suggested before Him, taking on greater prominence in the symbol of the Chalice and Host above. Below is the Grape, suggesting the Sacramental Wine.

Another sketch is devoted to the Resurrection. Our Lord comes forth from the dark tomb bearing the cruciform banner of victory. The sleeping soldiers are represented at His feet. Above is the traditional Phoenix rising anew from the flames of its nest, a symbol of the Resurrection, as is the Pomegranate below.

With your approval of these rough suggestions, we shall be glad to develop others of the series. We believe we can undertake these windows for five hundred dollars each panel, that is, each vertical group of five openings.

They will beautifully illuminate the Church and, at the same time, convey a lovely quality of pure, brilliant color. We are eager to start this series, for we are confident once one is in place others will be subscribed rapidly.

We are to make a sketch for an alternate arrangement - "the Committee have some concern regarding the lightness of the field in the side nave windows (see earlier designs made) ... Could more color be placed in them" "The Committee would also like to have a study of one window with the picture in the three center sections and the symbols in the top and bottom sections." (Make a design with more colorful fields - do not want to make the interior too dark. - this will increase the cost 9/26/61.

- Subjects to be
- | | |
|---|--|
| 1. The Annunciation, Luke 1:26-35 | |
| 2. The Nativity, Luke 2:15-20 | (Make the Annunciation in the new arrangement). |
| 3. The Epiphany, Matthew 2:1-12 | |
| 4. The Boy Jesus in the Temple, Luke 2:21-51 | |
| 5. The Baptism of Jesus, Mark 1:9-11 | (Make design for Nativity in new arrangement.) |
| 6. The Temptation of Jesus, Matt. 4:1-11 | |
| 7. The Good Samaritan, Luke 10:29-37 | Make designs for all aisle windows in new scheme, \$650 ea panel. "We are troubled on some Sundays with a br. sun at 11 o'cl. Service on S. side, so complete these first. |
| 8. Jesus walking on Sea, Matthew 14:22-23 | |
| 9. The Widow's Mite, Luke 21:1-4. | |
| 10. Jesus Blessing the Children, Mark 10:13-16 | |
| 11. The Transfiguration, Luke 9:28-36. | |
| 12. The Triumphal Entry, Mark 11:1-10 | |
| 13. The Last Supper, Luke 22:14-23. | |
| 14. Praying in Gethsemane, Luke 22:39-46 | |
| 15. The Crucifixion, Luke 23:32-33. | |
| 16. The Resurrection, Luke 24:13-27 | |
| 17. Jesus' Appearance to Disciples on road to Emmaus, Luke 24:13-27 | |
| 18. The Ascension of Jesus, Acts 1:6-11 | |

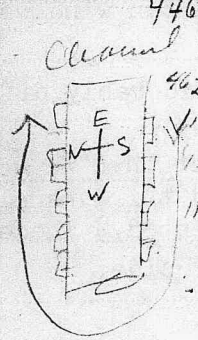

We have completed our studies of the designs for all your aisle windows, and are sending you the color sketches herewith.

#4463
The first from the chancel on the south are the ones we sent you some time ago, separately, and are here mounted in their proper relationship.

First, the Annunciation, with the Blessed Virgin kneeling below the angel holding the lily symbol. Above is the descending Dove of the Holy Spirit.

The companion Nativity window is devoted to the Mother and Child and Saint Joseph with his flowering staff. The traditional ox and the ass are above, with the star of Bethlehem casting down its rays. Below is the Lamb of God with the cruciform banner of victory.

#4463
Next is the Epiphany and the Boy Jesus in the Temple with the Doctors.

The three Kings bring their gifts to the Holy Child. In the upper section, the uneasy King Herod contemplates the implications of the star. The symbol of the Lion of Judah is represented at the base.

Above the young Christ in the Temple is the seven-branched candlestick, symbolic of Old Testament worship, while the lamp of enlightenment is represented below, "And the child grew, and waxed strong in spirit, filled with wisdom; and the grace of God was upon him."

#4621
The next pair is devoted to the Baptism of Jesus, and His Temptation.

Saint John the Baptist stands on the shore with the shell of Baptism from which descends the conventionalized water pattern. Above is the Dove of the Holy Spirit, and below the Tau Cross of Prophecy recalling John's recognition of Our Lord.

In the companion panel, Christ is represented on the mountain top, being offered the crown of the kingdoms of the world. Above is the ministering angel, and below the censer of prayer.

As suggested, the main theme is carried through the three central panels with symbols above and below. In this case, the Annunciation is represented, with the Blessed Virgin Mary kneeling below the angel holding the lily symbol.

Above is the descending Dove of the Holy Spirit, and below is the vase of lilies, symbol of the Blessed Virgin.

The palette is considerably deeper and richer than the earlier suggestion and, of course, the cost would be more. I think we can undertake the windows in this manner for six hundred fifty dollars each panel; that is, thirteen hundred dollars for a pair.

Dear I
We have completed a rough color sketch for the Nativity window in the design arrangement carrying the dominant theme through the three central panels; with the Star of Bethlehem above, and the Lamb of God below, all in the deeper and richer palette. We feel this will work out beautifully in the color and light of the actual glass.

Dec. 26, 1961