

This sheet for Hewitt & John only

CHARLES J. CONNICK : DESIGNER AND WORKER IN STAINED AND
LEADED GLASS : NINE HARCOURT STREET, BOSTON, MASSACHUSETTS

Note - vents were not furnished
3167

City or Town Champaign State Illinois No. 3167
McKinley Memorial Presbyterian Church,
Church Daniel, Fifth and John Streets. Date of One nave, September, 1951.
Donor and Address Mr. F. E. Berger, Berger and Kelley, Associates, Completion Spring 1953?
Architect 518 Lincoln Building, Champaign, Illinois. New vents \$15. to \$18. ea extra.
Denomination Presbyterian Quality of \$1800 ea (\$45. per foot).
and Minister The Reverend James R. Hine, The McKinley Foundation, Tel. Champaign Glass 62.44 - 62.85
119.24

Footage 40 feet each. sight 8464
Upper vents to be eliminated. Two lower vents
Ventilators to be retained. Wrska says present vents set by
in poor condition. Gave price of \$15. to \$18. each for new ones. Change them as each
Position in Church Nave window comes along.

Height from floor Protection Glass Groove Rabbit Stone Wood
Points of compass
Quality of light East and West.

Inscription Inscription for Matthew and John: "In loving memory of Byrd E. Bresee - 1875-1948." (10/21/52)

Design wanted soon as possible. Staging
Shipping address Blue-prints
Received

Bill to Dr. Hine may come in Jan to see progress. Templets from Wrska

Photos of Cartoons Mailed Make typical design.

General Information These windows are to be devoted to great leaders of all time, from Biblical to modern Presbyterian. Probably even some local figures. About 4-foot dominant figures with medallions and descriptive texts below, on light grisaille. (Suggested Little Boar's Head type.

They have a bad Good Samaritan window at present, which would have to be moved to some inconspicuous position at the end.

Perhaps order vents to be installed when second window set.

For addresses of those to be notified as window progresses, see other side.

Dr. Hine especially likes our window in the First Unitarian Church of Philadelphia; and the right and left lancets of the aisle window in Saint Chrysostom's, Chicago.

Following are his suggestions for the nave windows:

"As I suggested, I like very much the right and left sections of the south aisle window in Saint Chrysostom's Church in Chicago. My original thought was to have a scene of about this size, perhaps in a round medallion instead of a square for the

Wentworth

The seven temple lamps are indicated around the figure of the young Christ surrounded by the Doctors in the aureole, while the outer field is enriched with symbols of the Old and New Testaments, the Tablets of Moses, the Lamb of God supported by the Book of Seven Seals, the Globe surmounted by the Cross signifying Our Lord's domination over the world, and the lamp of revealed knowledge.

Growing grapevines enrich the field and outline the medallions, suggesting the significant text, "I am the Vine, ye are the branches".

We like the idea of single figures and related medallions in light silvery fields for the aisle windows. The typical sketch is devoted to John Knox and John Calvin. The broken fetters recall his suffering from the irons and lash of a French galley.

In the medallion below, he is represented preaching before Mary, Queen of Scots.

The significant text on the open book below is from Knox's writings, "Merchandise have I not made of the glorious evangel of Jesus Christ".

In the medallion of the Calvin panel, he is represented in his significant preaching at Geneva; and the text is from a letter to Cramer, "I should cross ten seas if Holy Communion might prevail among the members of Christ". Perhaps you will have in mind texts that you would particularly like to use here.

The tracery member is enriched with the torch of zeal of Protestant Reformers.

Dr. Hine especially likes our window in the First Unitarian Church of Philadelphia; and the right and left lancets of the aisle window in Saint Chrysostom's, Chicago.

Following are his suggestions for the nave windows:

"As I suggested, I like very much the right and left sections of the south aisle window in Saint Chrysostom's Church in Chicago. The original thought was to have a scene of about this size, perhaps in a round medallion instead of a square for each of our windows. I like the idea of quite a bit of white space around the medallion. My second choice would be the east nave window in the First Unitarian Church, Philadelphia. ...the students would like the scene better than the single figure. It would mean more to them. Of course, the single figure can be treated in such a way that the significance of a person's work can be illustrated.

Suggestions for 2 windows would be to have one in which John Knox is pictured and John Calvin in the other. The second would be two figures that were very prominent in the early history of the Presbyterian Church, here in America. One is Francis Makemie; a good man to team with him would be John Witherspoon, early president of Princeton College, and also a signer of the Declaration of Independence."

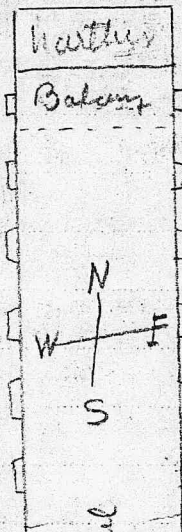

Make new typical design - keeping price down as near as possible to \$1800 each window. We feel that the principal figures should be represented in each window - perhaps making them considerably smaller than they are in our first sketch. The theme of the entire church is "Christ's Call to service and those who followed Him".

The front aisle window on the east would be the disciple window with Matthew and John represented in it. Opposite on the west, working toward the back, would be the Augustine and early church window, and opposite, on the west, the St. Francis and contemporaries window, perhaps using symbols of Augustine's time and contemporaries in one and picture of him in a given situation in the other panel. The same thing would be used in the treatment of the St. Francis window. The next window, working back on the east, would be the Calvin-Knox window, and opposite, on the west, the Zwingli-Luther window - these sections representing the Reformation.

Note: develop rest of designs "in action medallions" 5/15/52 and 6/12/52.

suffering from the irons and lash of a French galley.

In the medallion below, he is represented preaching before Mary, Queen of Scots.

The significant text on the open book below is from Knox's writings, "Merchandise have I not made of the glorious evangel of Jesus Christ".

In the medallion of the Calvin panel, he is represented in his significant preaching at Geneva; and the text is from a letter to Cranmer, "I should cross ten seas if Holy Communion might prevail among the members of Christ". Perhaps you will have in mind texts that you would particularly like to use here.

The tracery member is enriched with the torch of zeal of Protestant Reformers.

We have taken the first window from the chancel on the east for our theme, with ~~figures~~ and symbols of Saint John and Saint Matthew.

In a very light simple field, we have represented their evangelical symbols, the eagle and the winged man, and their apostolic symbols, the chalice and dragon or serpent, and the purse of money.

Above the principal medallions are kneeling members of the heavenly choir, with trumpets, - angels of praise; and in the tracery member, the censer, symbolic of prayer.

The border is designed in the grapevine motif, suggesting Christ and His Church and the text, "I am the Vine, ye are the branches."

Just as we were finishing this sketch and again studying your suggestions, I think we finally came to a realization of what you have in mind for these figures; that is, the idea of their doing things to bring out the significance of their work. And so we have prepared alternate suggestions for the dominant medallions rather than having them holding their evangelistic books and pens.

use these
The rough additional suggestions represent Saint John with his net at the time of his calling to be one of the fishers of men; and Saint Matthew with his records and funds as collector of customs.))

I think this same plan would work out very well throughout the entire series, and we are very enthusiastic about it. If you like the idea, we shall be glad to develop it in others of the series. It works in beautifully with the over-all theme of Christ's Call to Service and Those who Follow Him.

South rose.

Chancel.

South rose.
Chancel.
See Wicks's floor
Plan in folder
Timothy

IN 3:47

Matthew
John

(Founders)

Timothy
Paul.

Augustine (Early Church)
& early Doctors St

St. Francis
& contemporaries.

Dr.Hine wants the figures to be done in deep, rich color which will highlight them in terms of the rest of the window

East.

West

Calvin
Knox.

(Reformers)

Luther
Zwingli.

Later,
17th or 18th cent.

19th or 20th
centuries.