

*Note - if we get the
Fry window
it is wanted
with this
one*

No 3514

Place Winnetka, Illinois.

Building Christ Church, Sheridan Rd. and Humbolt Av Date of Completion Sept 15, 1954
Donor: Mrs. John M. Butler, 5/13/54
Persons Interested ~~The Reverend S. Ashley Gerhard, D.D. Rector.~~

Correspondence with Mr. Thomas C. Jones, Alumimum Co. of America, 520 N. Michigan Av. Chicago.

Minister ~~See above~~ The Rev. Charles F. Schreiner Denomination Episcopal.

Architect..... Price: \$2000 ~~or group~~ (\$50.00).
There are vents in all panels now; but the 2 central ones can be eliminated.
Vents..... *Loss 44 1/2 % 89349*

Position in Church ~~Aisle window South wall, directly opposite the one stained window on the north wall.~~ Fourth from entrance.

Height from floor 67 inches. Protection Glass Groove Rabbet Metal Stone Wood *Wood*

Exposure South Footage *44'*

Inscription ~~None in the glass. To be on bronze tablet below. Move the names of the saints to the outer panels, and have the memorial inscription in the two center panels, as follows: "To the Honor and Glory of God in loving memory of John Mcigs Butler / To the Honor and Glory of God in loving memory of Gerald Norton Butler." / December 8, 1892 - January 17, 1953.~~

Design wanted soon as possible. Staging.....

Templates *W. J. ...* Blueprints.....

General Information Design wanted for typical sketch - Peter and Andrew.....

They would like to carry out the same arrangement as the Fry window - with the two saints in each group with their stories developed in medallions in the outer panels.

Miss Fry's window is practically red, white and blue. The two central panels with white figures and red cloaks and violet-blue fields. Two side panels, violet-blue angel groups, busts. Red background, brown ornament, all reds about sanded ruby color. Figures 4 1/2" high. Feet 6" from bottom.

There is a window over the altar that they call a Tiffany window - Christ Blessing Children. In the opposite end is a Heaton, Butler and Bayne Sermon on the Mount apparently.

There are 7 groups of aisle windows, 4 on one side, and 3 on the other. The middle aisle window on the Epistle side is by Miss Fry.

See report of April 30, 1953, for information and price and subject suggestions for other windows there.

Note: When we set our windows, they would like us to lighten the Fry window, in an attempt to brighten it and bring it into better harmony with ours.

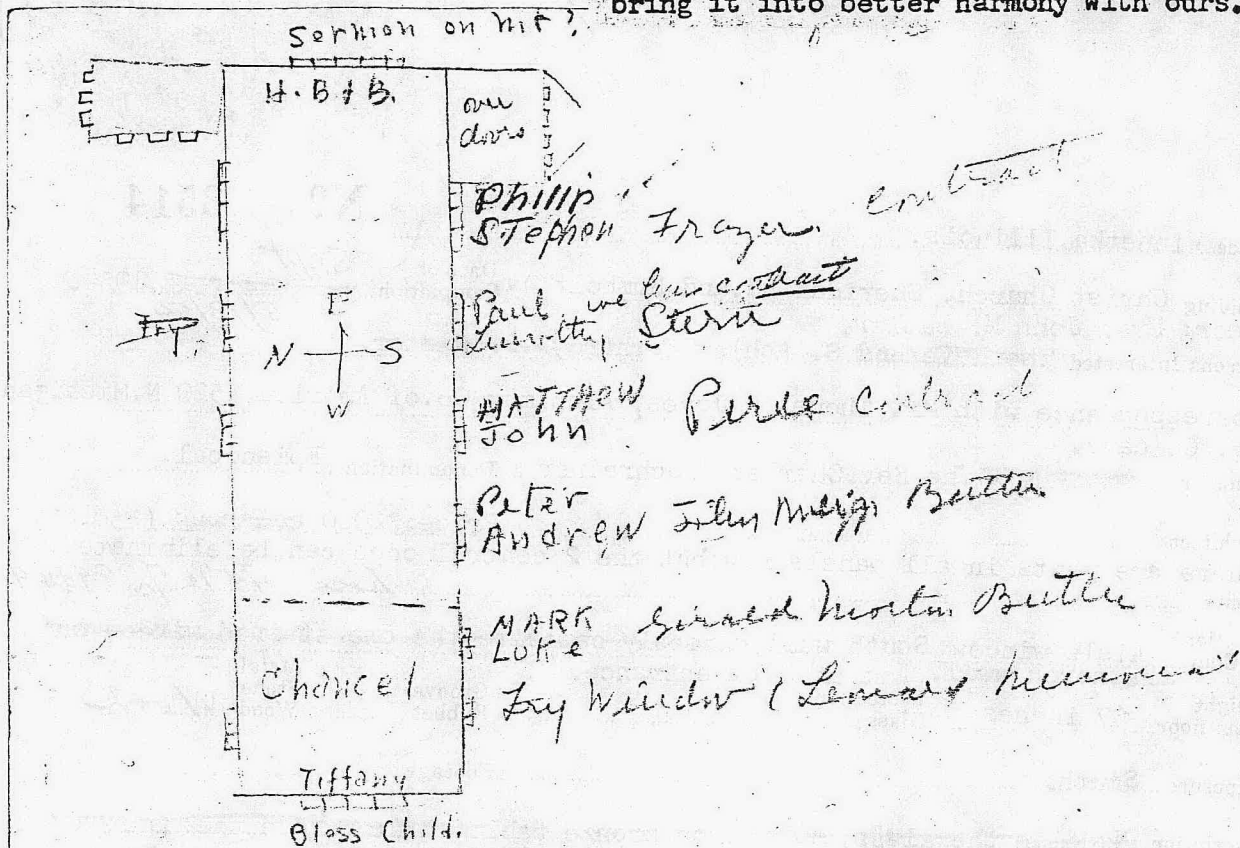

We have completed the color sketch for the typical aisle window at Christ Church, and are sending it to your office, with a copy of this message to Mr. Jones, having in mind that at this season many people are on vacation.

In planning the design we have kept in mind the aisle window now in place, and although it does not closely follow the plan of that window, we feel that the general proportion and scale will harmonize very well.

Again, the color scheme introduces quite wide variations, but as we hope to continue the series, the windows would be characterized by still other variations within the scope of a harmonious whole.

As planned, the window is devoted to the first two of Our Lord's Apostles, Saint Peter and Saint Andrew. Their figures are represented in the central panels - Saint Peter with his traditional keys and the fisherman's net, and Saint Andrew with his distinctive diagonal cross.

The subjects of the panels at either side further develop the theme of the central figures. Designed in medallions, the one at the left represents Our Lord Washing Peter's Feet; while at the right Saint Andrew's first meeting with Jesus is symbolized.

We thought it might be well to indicate the names and Biblical references at the bottom. A brief but significant quotation might be used in place of the citations, or if you prefer, the space could be well designed in the border with a foliated pattern.

This pattern is further enriched in the two central panels, with stars of heavenly steadfastness.

We have kept in mind the appropriation of two thousand dollars for the group of four panels.

The same general plan, with variations would work out beautifully in the other windows, devoting them to Our Lord's apostles.