

5300  
5300  
4800

CHARLES J. CONNICK : DESIGNER AND WORKER IN STAINED AND  
LEADED GLASS : NINE HARCOURT STREET, BOSTON, MASSACHUSETTS

City or Town Worcester, State Mass. No. 2627

Church Wesley M.E. Church. Date of Completion Sept. 1, 1948.  
Donor and Interested: Mr. Edward F. Miner, 3 Foster St. Worcester 8, Mass.  
Address .....

Architect Harry J. Carlson.

Denomination Methodist

and Minister .....

~~2 windows in south transept (87' ea.)~~  
Footage 2 longer windows in N. Trans (88' ea.) Sizes, full sight Shorter \$4800 (54.54)  
1 shorter in e. Wall of N. Trans, 88'

Quality of Glass ~~in S. trans. \$2300 ea (\$55.)~~  
2 in N. Trans. \$5000 ea  
Longer \$5300 ea (\$60.22)

Ventilators Retain all 3 vents in the easterly wall; Set by  
Omit all vents in the 2 windows in northerly wall (2/25/47)

Position in Church Transept windows. (See other side).

Longer: 29 feet

Height from floor Shorter 20' Protection Glass Groove Rabbet Stone Wood

Points of compass 2 north; 2 south.

Quality of light 1 east

Inscription .....

Design wanted ..... Staging .....

Shipping address ..... Blue-prints Received .....

Bill to ..... Templets .....

Photos of Cartoons Mailed .....

~~Windows in south gallery to harmonize with those in the north.~~  
General Information Later leaders of the faith.

Book: "The Story of Methodism" by Halford E. Luccock and Paul Hutchinson.  
Published by The Methodist Book Concern 1926. Library No. 5548.156.

The windows of the north transept are to be devoted to great leaders of Methodism, symbolized in figures and related medallions. The one, facing north, at the right, is to represent Wesley founders, - the first Charles, and John (1703-91); at the center, ~~and~~ Susannah, the Mother; at the right, Charles.

The one at the left would be devoted to the early Founders - William McKendree (1757-1835), Thomas Coke (1747-1814), and Francis Asbury (1745-1816).

In the side wall, facing east, the missionary bishops William Taylor, (1821-1902), James M. Thoburn, (1836-1922), and James Whitford Bashford (1849-1919).

Mr. Harry J. Carlson, the Architect, to be consulted on all work.

For addresses of those to be notified as window progresses, see other side.

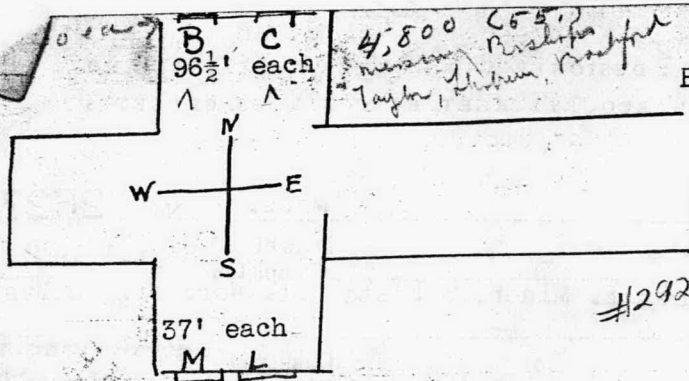

- North Gallery -  
 B - Early Bishops: McKendree, Coke, Asbury  
 C - Wesley Founders: Charles, John, Susanna
- South Gallery -  
 L - Modern Women: Frances Willard, Isabelle Thoburn, Barbara Heck.  
 M - Women of the Bible: Dorcas, Mary Magdalene, Ruth.

The committee... together, the

and  
 at by  
 the Woman's foreign... in the North... and  
 in her way was as remarkable as her Brother, the Bishop.

Re: Women of the Bible, ... Mary Magdalene was at the Crucifixion and saw Him hurriedly buried. She also was first at the tomb and the first to whom Christ appeared. Ruth was selected because she was from the Old Testament, was from a pagan people, adopted Judaism and by her second marriage came into the line of David and so of Christ; representing the universality of Christ and his teaching.

For the John Wesley lancet (left), *see report of hv. 25, 1947* Dominating figure of John Wesley; medallion below, Rescued from Fire at Burning of Epworth Rectory; bottom medallion, Wesley preaching in the open (Possibly on father's tombstone.)  
 Suzanna Wesley lancet (center), Dominating figure of Suzanna Wesley; medallion below, Suzanna teaching a child of five; base medallion, John Counselling with Suzanna. (See note of Oct. 21, about Samuel Wesley)  
 Charles Wesley lancet (right). Dominating figure of Charles Wesley; medallion below, The Oxford or holy club. Base medallion, either of the following three hymns, whichever can be best symbolized; Hymn, Jesus, lover of my soul - Hymn, O for a thousand tongues to sing my great Redeemer's praise, - Hymn - Love divine all love excelling. Hark, the herald angels sing. Christ the Lord is risen today. NO VENT IN THIS WINDOW.

Contract says Mr. Carlson to supervise work. We to take out present glass which becomes property of the church. Furnish drop cloths and protect well - obtain permits for staging erected on public property, furnish condensation gutters.

*Founders*  
 For the Early Bishops Window (*see report of hv. 25, 1947* westerly window in the north wall) is to be of Coke, Asbury and McKendree; Coke in the center lancet, Asbury at the left as you look at the window from the inside and McKendree at the right; medallions to be under each of the foregoing figures; of Asbury, Lukeman's (?) monument of Asbury in Washington, D.C., of Coke, something of the Christmas or Baltimore Conference at the Lovely Lane (?) meeting house and under McKendree, some incident of his life. (See note of Oct. 21, about McKendree)  
 The Mission Window in the easterly wall is to be of Thoburn, Bashford and Taylor; Bashford at the left as you look at the window from

This window is devoted to the Wesley family, with Susannah Wesley in the central position. At her right is John Wesley, with the closed book; and at her left, Charles Wesley, with a pen and scroll of music.

In the medallion immediately below Susannah, Samuel Wesley is represented writing his work, "The Life of Christ". The lower medallion is devoted to Susannah Wesley teaching her young son John, and is symbolical of all the devoted instruction of her children.

The medallion below John Wesley represents him preaching in the fields to the miners. In the background is the superstructure of a mine.

Below the figure of Charles Wesley, he is represented composing hymns. The small insert of Our Lord suggests the inspiration of "Jesus Lover of My Soul".

In four side tracery members, Angels of Praise bear trumpets, while in the central ones are Angels of Prayer with censers.

In upper tracery members are symbols of the lamp and the book of enlightenment and knowledge; the bell, suggesting the call of the Gospel, and the descending dove of divine inspiration.

Through the blue field and tracery are flames eyes of divine soul, while stars suggest heavenly steadfastness.

The Missionary Window  
In the east wall of the north transept,  
Wesley Methodist Church, Worcester.

Three great Methodist missionary leaders are here symbolized in color and light, - James Whitford Bashford, James Thoburn, and William Taylor.

The central position is given to Bishop James Thoburn, who holds the Bible. In the medallion below he is symbolized baptizing converts in India. It is recorded that in his last year he baptized in one day over one thousand natives. The lower medallion represents the laying of the cornerstones of Isabel Thoburn College, where, under the direction of his sister, Isabella, so many women of India have been trained in the Christian life.

At the left, James Bashford <sup>see note \*</sup> holds a scroll; and, in the medallion below, his gift of writing is symbolized. He is surrounded by a group of his Chinese converts.

William Taylor is also symbolized with books, which he sold to finance his travels; and the medallion suggests his travels through Africa in native boats. The converts loved him, and would follow as far as possible on land.

The grapevine motif, used through the field, suggests the spread of the Gospel, the growth and richness of the missionary's influence upon the people, and the significant theme, "I am the Vine, ye are the branches".

Through the tracery eaders symbols of churches recall missionary fields. Trees symbolize the wilderness; flames, the religious zeal of the missionaries. This theme is again suggested in the book, staff and scallop shells of missionary endeavor.

Angels of Prayer enrich the central tracery.

The Bishops' or Early Founders Window, in the North Transept, first from the chancel, Wesley Methodist Church, Worcester.

This window is devoted to the three great leaders of early Methodism, Francis Asbury, Thomas Coke, and William McKendree.

Bishop Asbury is represented in the dominant position of the central lancet in an attitude of preaching. In the medallion immediately below, he is symbolized as the circuit rider facing the perils and adventures of the wilderness. The lower medallion is symbolical of his visit, with Thomas Coke, to George Washington petitioning him for the emancipation of slaves.

Below the figure of Thomas Coke, in traveling costume, is suggested the Christmas Conference of 1784 in Lovely Lane Chapel in Baltimore. The figures might suggest Thomas Coke, John Dickins, who made the motion to form the Methodist Episcopal Church, and Asbury.

William McKendree is also represented in the attitude of preaching, in frontier clothes; and the medallion below recalls his mission to the early settlers. In the field is his horse and a stockade.

Pomegranates through the ruby field, symbolize the unity and power of the Church.

Through the minor tracery members are symbols significant of the life of the early founders in the wilderness: a plow, a spinning wheel, a turkey, a church, an ear of corn, a covered wagon, a log cabin, and a buffalo.

In the central tracery members are symbols of Praise and Prayer with trumpet and censer; and at the sides are the anchor of hope and the cross of faith.

In the upper quatrefoil is The Holy City, symbolizing the Church that cannot be hid. Stars symbolize divine steadfastness; and flames, religious zeal.

Note: Mr. Miner sent a clipping from the Christian Advocate of Aug. 16, 1945, with a sketch of Bishop Francis Asbury

April 3, 1948.

Worcester, Massachusetts.  
Wesley Methodist Church.

Mr. Skinner went to Worcester to meet the committee at 3 P.M.

Everyone was pleased with the designs.

Carlson noticed the fact that the medallions in the Missionary window stood out more distinctly than in the other windows, and we pointed out that this was largely because they were in a straight tier rather than staggered.

He thought that the medallions were lost more in the Early Founders Window, and that they took their place just about right in the Wesley Window.

We should have this relation of the medallions to the field in mind as the three windows are developed.

Carlson also objected to the pose of the figure of <sup>X</sup>Bashford, but I defended it on the grounds that it seemed to have something quite typical and characteristic of the period. Anyway, he wishes we would study this carefully in the full sized drawings, to have not more than one leg bowed. He thinks that if Bashford were a horseman that would be all right.

They would like to have us consider the possibility of putting an episcopal robe on Coke. <sup>see \*\*\*</sup> They say that he did less traveling than the others, and they felt that his trousers were a little too much in evidence. If the robe doesn't work, perhaps we can show less of the division between his legs.

November 25, 1947.

Re: Wesley Methodist Church, Worcester.

Report of conference at Wesley Methodist Church with Mr. Miner, Mr. Carlson, Mr. MacCullough, and Dr. Fallon.

It was decided that for the Wesley window under John, we would represent him preaching in the fields, possibly suggesting in the background a silhouette of the superstructure of a mine, the big wheel that hauls things up and down the shaft. We can probably easily get a picture of one of these.

Under Susannah, the upper medallion would be Samuel Wesley writing. In the actual glass we could indicate the name of his book in very small letters. The lower medallion represents Susannah counselling her young son, John.

Under Charles Wesley, he would be represented composing his hymns and a little insert could symbolize one of these hymns. For instance, a vision of Christ to represent "Christ the Lord has Risen today", or "Jesus Lover of my Soul".

Mr. Miner would like to have this window in the second position from the Chancel, that is, the right hand one of the two facing north.

In the Bishop window they would like to have Asbury as the central figure with the Coke at the left, and McKendree at the right.

Under Coke, would be a medallion symbolizing the Baltimore Conference. Miner knows of a coin or medal of this which he is going to get and loan us. (We now have this).

Under Asbury would be the circuit rider and suggestions of the perils of the wilderness, and below that the visit to Washington with Washington in the center welcoming Coke on one side and Asbury on the other. McKendree preaching in frontier clothes to the early settlers would be under his figure.

There is still a little doubt about the medallions in the Missionary window, but the figures remain as planned. That is, Bashford, Thoburn, and Taylor. *Perhaps Bashford & Thoburn under general heading of Education; Bashford could be writing, while Thoburn could be either baptizing, or being the commissioner of the College. Either traveling or &* They would like to have the Wesley go forward first in the hope that some of it would be completed and seen here in the studio at the time of the conference next summer. They would like to have as much variety and difference in these three windows as possible, both in color and form to avoid monotony.

Angels in tracery.

*\* baptizing as the symbol under Taylor?*

The background designs of each of the above three windows to be different, with each background suggestive of the subject of the window as a whole or of the subject of each lancet, with no grisaille or stock patterns.

July 24, 1947. Worcester, Massachusetts.  
Wesley Church.

Mr. Skinner's report:

The backs of the pews cover up almost two-thirds of the distance up to the present vent lines in the two north windows of the transept.

The pews cut into the left-hand panel of the east window in this transept, but not so badly. We should not have anything important below the obscured portions.

~~The~~ The southerly nave windows open into an enclosed court, with protection glass in hinged frames about 15 or 16 inches, away from the actual window. These are in three sections in height, and open out, away from the permanent window.

A good-sized division, about 4 inches runs horizontally, one at the top of the heads of the lancets, and one almost half way up the lancets.

There is a flat concrete floor just below the bottom of the windows on the outside that will support scaffolding, and it is possible to get the scaffolding into this space through the printing shop.

These horizontal divisions, especially the lower one, will have to be considered very carefully. These windows are pretty well shaded by the opposite wall, but they get some skylight in the tracery, especially the middle one.

OES/rmh.