

CHARLES J. CONNICK : DESIGNER AND WORKER IN STAINED AND  
LEADED GLASS : NINE HARCOURT STREET, BOSTON, MASSACHUSETTS

City or Town Floydsburg, State Kentucky. No. 1960

Church Duncan Memorial Chapel. Date of Completion .....

Donor and Address Mr. A. E. Duncan, Commercial Credit Co. Baltimore, Maryland.

Wischmeyer, Arrasmith and Elswick, 1303 Heyburn Quality of Glass See Prices suggestions \*\*

Architect Building, Louisville, Ky. Denomination and Minister .....

Chancel Window 41'; 2 Transept 41' each; Footage 7 Aisle 7 1/4' each. sight Sizes, full .....

Ventilators Yes\* Set by .....

Chancel window, 2 Transept windows, Position in Church 7 aisle windows.

Chancel 8' f.f.; transept 8' f.f. Protection Glass See diagram of groove sent in letter of Dec. 9, 1936.

Aisle 5' f.f. Points of compass Chancel Window, north; 2 Transepts, 1 E and 1 W;

Quality of light Aisles 4 West, 3 East.

Inscription .....

Design wanted December 21, 1936. Staging .....

Shipping address .....

Bill to .....

Photos of Cartoons Mailed .....

General Information Sketch wanted for chancel, typical transept, and typical aisle, all to be in best workmanship, and all installed at one time. The Chapel is in a small country cemetery, where many members of the Duncan family have been buried, and "my wife, who died last June, will be buried in front of the altar, where I also expect to be buried. This cemetery is in sight of my home and that of my grandfather, and therefore, has much sentiment connected with it for me, especially as Mrs. Duncan and I started our first four years of married life within one mile of the Cemetery. Some years ago I bought the ground upon which the schoolhouse that I first attended was situated, tore down the building and gave the ground to the Cemetery. With this background, I hope you can design something particularly attractive. Possibly the chancel windows might well represent the "Resurrection".

In all of the above work I do not like large figures or large pieces of glass, and I like but little real red color.  
For addresses of those to be notified as window progresses, see other side.

*made by panel in case*

*Deane Memorial*

Chancel Window. Footage 41 feet.	\$60. per foot	\$2500.00
2 Transept Windows. Footage 41 feet each.	\$60.00 per foot (\$2500 each).	\$5000.00
7 Aisle Windows, Footage 7 1/4' each.	\$70.00 per foot (\$500.00 each)	\$3500.00
Window over Entrance. Footage 9 1/2 feet	\$65.00 per foot)	600.00
		\$11600.00

~~\$2500 (\$60.)  
500 70.  
600 65.~~

de suggestions.  
Church, Worthington  
s copy.

If all the windows were contracted for at one time, the total price would be reduced ten percent.

of the Resurrections: The Raising of Lazarus; and The Raising of the Widow's Son.

The figure of the Risen Christ with the banner of victory is, of course, given the dominating position in the central lancet, with the three Marys at the Tomb in the head of one side, balanced by Saint Peter and Saint John at the Tomb at the other side.

The Peacock and the Phoenix, ancient symbols of the Resurrection, are designed above them, and the background pattern is a conventional form of the lily symbol of the Resurrection.

I am suggesting that one of the transept windows be devoted entirely to significant Parables, with the opposite one representing the Miracles.

For the aisle windows, I suggest the Works of Mercy, which, as you recall, was indicated as

*SCHEME B  
in my earlier outline*

1960

Chancel and Transepts	\$2100 (\$60.)	to	\$2500 (\$60.)
Aisles	420 60.	"	500 70.
Over Entrance.	520 55.	"	600 65.

We sent rough sketch suggestions on Nov. 22, with the price suggestions.

Note: that Mr. Duncan has seen the windows in St. John's Church, Worthington Valley, and liked them.

See copy of suggested plan in folder. Cartwright also has copy.

I am sure you will be interested in my ideas as they are developing. First of all, I have taken your suggestion of the Resurrection as the central theme of the chancel group in the Duncan Memorial Chapel. It is planned in medallions, arranged in a general way as indicated in the small scale sketch which I first sent you. In the lower tier of medallions across the three lancets I am symbolizing Old Testament types of the Resurrection - Elijah's Ascent in the Chariot of Fire; Daniel in the Lion's Den; and Jonah Belivered from the Big Fish.

In the central tier are New Testament types of the Resurrections: The Raising of Jairus Daughter; The Raising of Lazarus; and The Raising of the Widow's Son.

The figure of the Risen Christ with the banner of victory is, of course, given the dominating position in the central lancet, with the three Marys at the Tomb in the head of one side, balanced by Saint Peter and Saint John at the Tomb at the other side.

The Peacock and the Phoenix, ancient symbols of the Resurrection, are designed above them, and the background pattern is a conventional form of the Lily symbol of the Resurrection.

I am suggesting that one of the transept windows be devoted entirely to significant Parables, with the opposite one representing the Miracles.

For the aisle windows, I suggest the Works of Mercy, which, as you recall, was indicated as "Scheme B" in my earlier outline.

rotated vent section at the bottom.

*Residence Museum at Landsburg Ky*

WTR  
Nov. 17, 1936

(slightly taller)  
42' - thin beams.

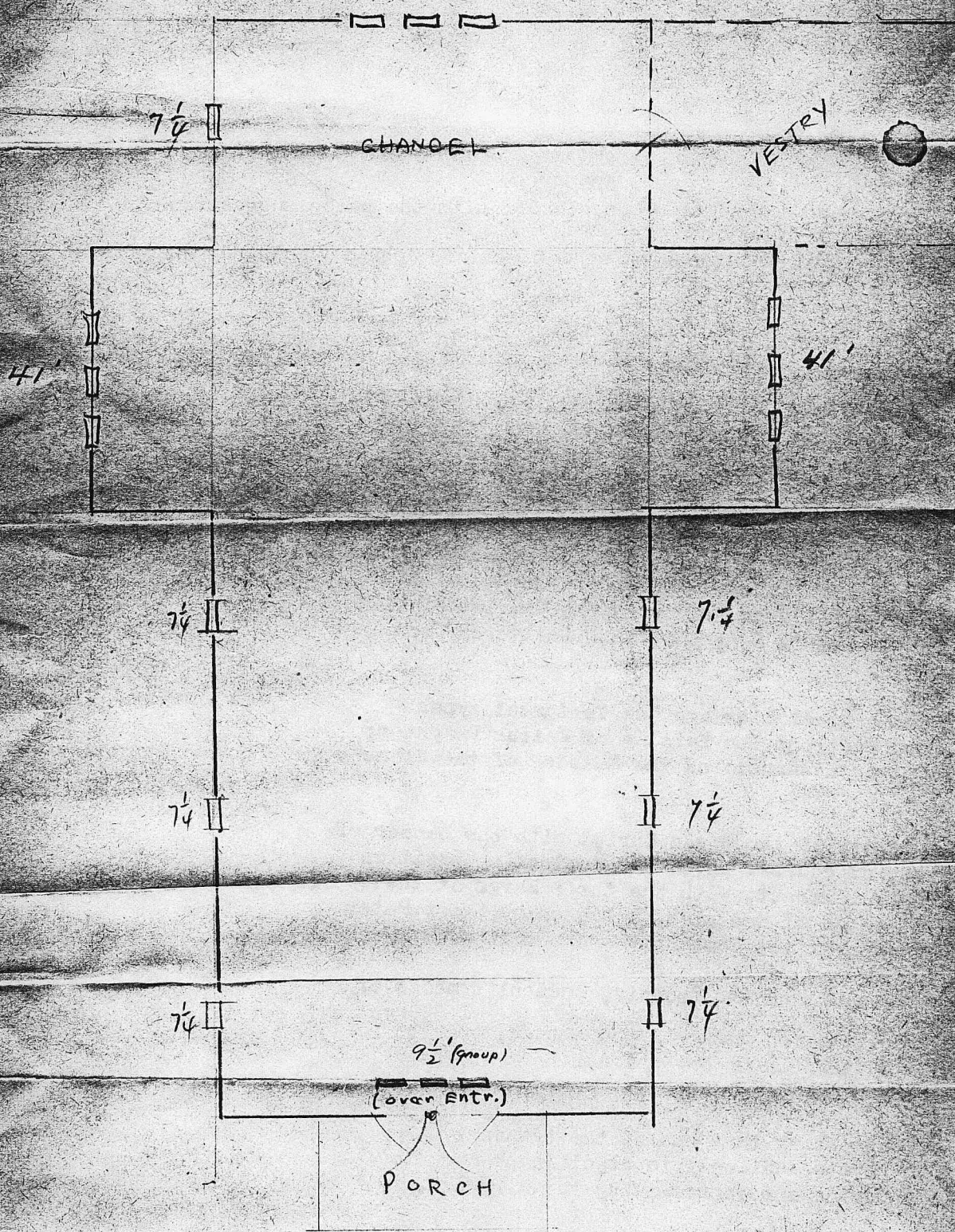

n. exposure on B.P.

1960

Chancel Window. <sup>**</sup>	\$60. per foot	\$2500.00
Footage 41 feet.		
2 Transept Windows.	\$60.00 per foot	\$5000.00
Footage 41 feet each.	(\$2500 each).	
7 Aisle Windows,	\$70.00 per foot	\$3500.00
Footage 7 1/4' each.	(\$500.00 each)	
Window over Entrance.	\$65.00 per foot)	600.00
Footage 9 1/2 feet		

<del>\$2500</del>	<del>(\$60.)</del>
<del>500</del>	<del>70.</del>
<del>600</del>	<del>65.</del>

See suggestions.  
Church, Worthington

s copy.

\$11600.00

If all the windows were contracted for at one time, the total price would be reduced ten percent.

of the Resurrections: The Raising of Lazarus; and The Raising of the Widow's Son.

The figure of the Risen Christ with the banner of victory is, of course, given the dominating position in the central lancet, with the three Marys at the Tomb in the head of one side, balanced by Saint Peter and Saint John at the Tomb at the other side.

The Peacock and the Phoenix, ancient symbols of the Resurrection, are designed above them, and the background pattern is a conventional form of the Lily symbol of the Resurrection.

I am suggesting that one of the transept windows be devoted entirely to significant Parables, with the opposite one representing the Miracles.

For the aisle windows, I suggest the Works of Mercy, which, as you recall, was indicated as "Scheme B" in my earlier outline.