

CHARLES J. CONNICK : DESIGNER AND WORKER IN STAINED AND  
LEADED GLASS : NINE HARCOURT STREET, BOSTON, MASSACHUSETTS

City or Town Peterborough, ✓ State N.H. ✓ No. 1963  
Church All Saints' Church. ✓ Date of hr 1 All Saint Day  
Donor and Mrs. E.M. Little, 149 N. State St. Concord, N.H. ✓ Completion December 6, 1937.  
Address Mrs. Mary L.C. Schofield, interested. ✓  
Architect Cram and Ferguson. ✓ Quality of Glass \$400. (\$40. per foot).  
Denomination Episcopal.  
and Minister Mr. McKee, Rector ✓  
Footage 10 feet. ✓ Sizes, full sight  
Ventilators No. ✓ Set by  
Position in Church West window in Baptistery. (West Wall of North Transept.) ✓  
Height from floor 4 1/2 feet ✓ Protec- Groove Stone  
tion Glass Rabbet Wood  
Points of compass  
Quality of light West. ✓  
Inscription (Mr. Cleveland says inscriptions cut in stone sills.) ✓  
Design wanted Staging  
Shipping address Blue-prints  
Received  
Bill to Templets  
Photos of Cartoons Mailed  
General Information (Mrs. Schofield goes away the 20th of January). Have  
cartoon for Mrs. Schofield to see late in April.  
Blue is the predominant color in the Lady Chapel (the opposite transept)  
red to predominate in the Baptistery windows. See description of sketch  
on other side.

For addresses of those to be notified as window progresses, see other side.

The Saint Nicholas Window  
To be Placed in the Baptistry of All Saints' Church,  
Peterborough, New Hampshire.

The prevailing idea of this window relates first of all to Saint Nicholas as the Patron Saint of Children.

The symbolical figure appears robed as a ~~priest~~<sup>bishop</sup> in the Western or Latin Church, holding his crozier, the three bags of gold and with his right hand raised in blessing.

The dominating color is red. It appears with telling effect in the costume, in the background of the Christmas Tree medallion, and in the borders.

The base medallion wherein is featured the Christmas Tree, is a most significant feature of this design. Although the Christmas Tree, alive with candles, may not be called an ecclesiastical symbol, its meaning is doubly important in this window which, in a very real way, will belong to the children of "The Mountain Mission by Mail".

This significance of the window will be made eloquent by the use of small figures throughout several of the lower diamond shapes. These figures will be of the boys and girls of the mountains, the trees, flowers and animals of the same mountains.

In other words, this Baptistry window will be the Saint Nicholas Window with full emphasis upon the clearest implication of that title. It will be a children's window, gratefully acknowledging the benign spirit of helpfulness to children as it is known in and through "The Mountain Mission by Mail."

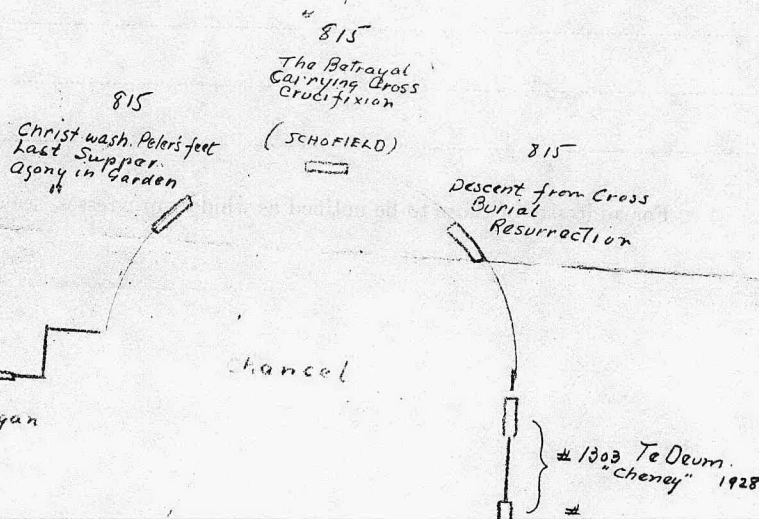

1963

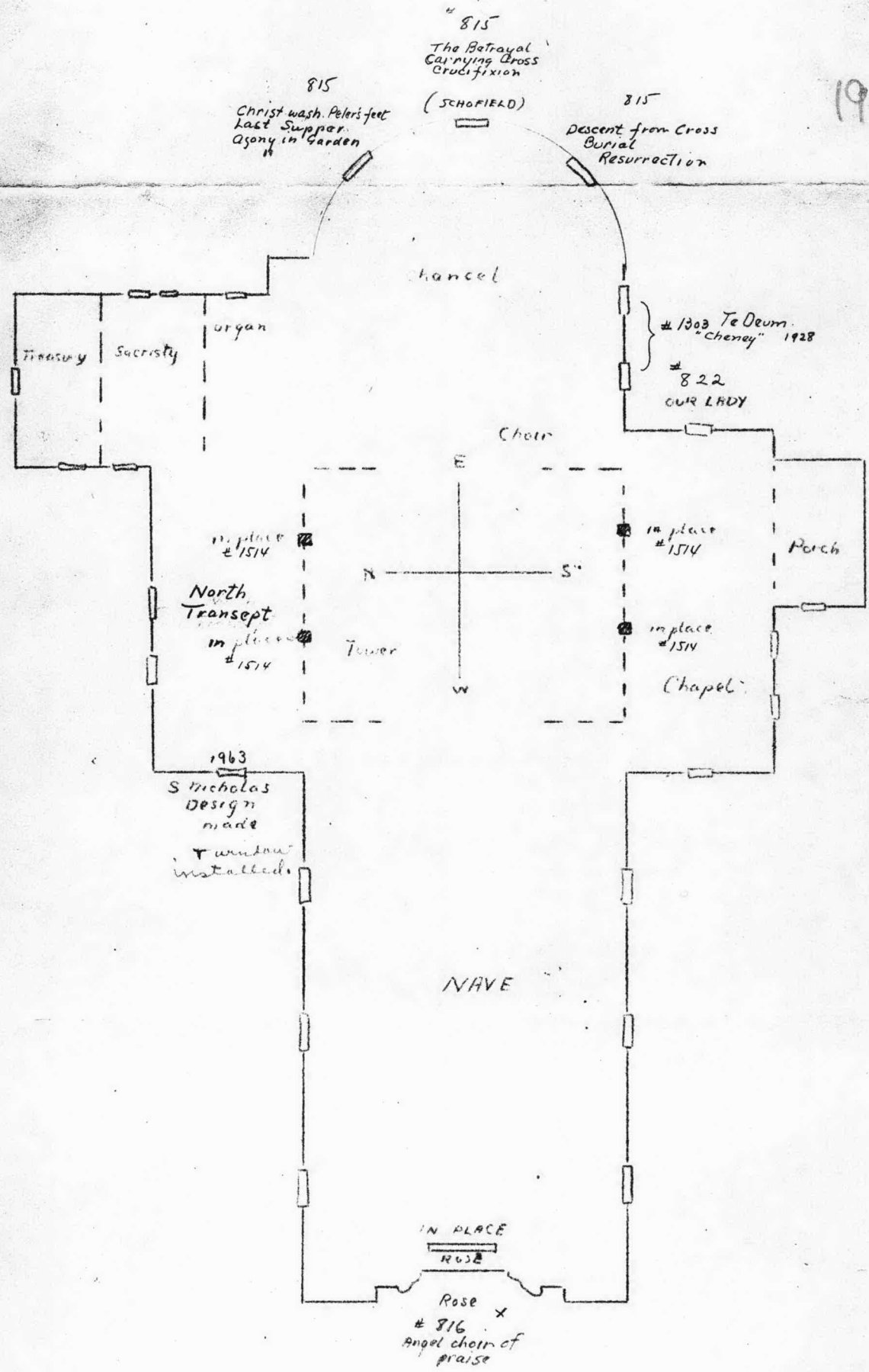

Peterboro, N.H.  
 All Saints Epis. Church  
 12/2/36 WTR

Have this diagram on card  
 when job is finished.